

Outdoor Full-Color Bullet Network Camera

MODEL: VIGI C340(2.8/4/6mm)



4MP | H.265+

VIGI C340(2.8/4/6mm)



Human & Vehicle
Classification



Smart Detection



IP67



Two-Way Audio



Onboard Storage*

// Human & Vehicle Classification

Intelligently distinguishes humans and vehicles from other objects, so you receive more accurate event notifications.



// Smart Detection

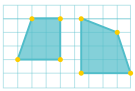

Intrusion
Detection



Line-Crossing
Detection



Object Removal
Detection



Object Abandoned
Detection



Region Entering
Detection



Region Exiting
Detection



Motion
Detection



Camera
Tampering

// SmartVid



Smart IR

Keeps objects from being under-rendered when far away or overexposed when close to camera at night.



Wide Dynamic Range

Adjusts for lighting contrast to minimize shadowing effects and renders images true to life.



3D DNR

Removes abnormal pixelation to provide clearer video and eliminate distortion.

// VIGI Surveillance Solution

The VIGI professional surveillance system by TP-Link is dedicated to protecting the business that you've worked hard to build—whenever, wherever.

Outstanding functions, reliable quality guarantees, and simplified installation work together to ensure your business stays safe and sound.

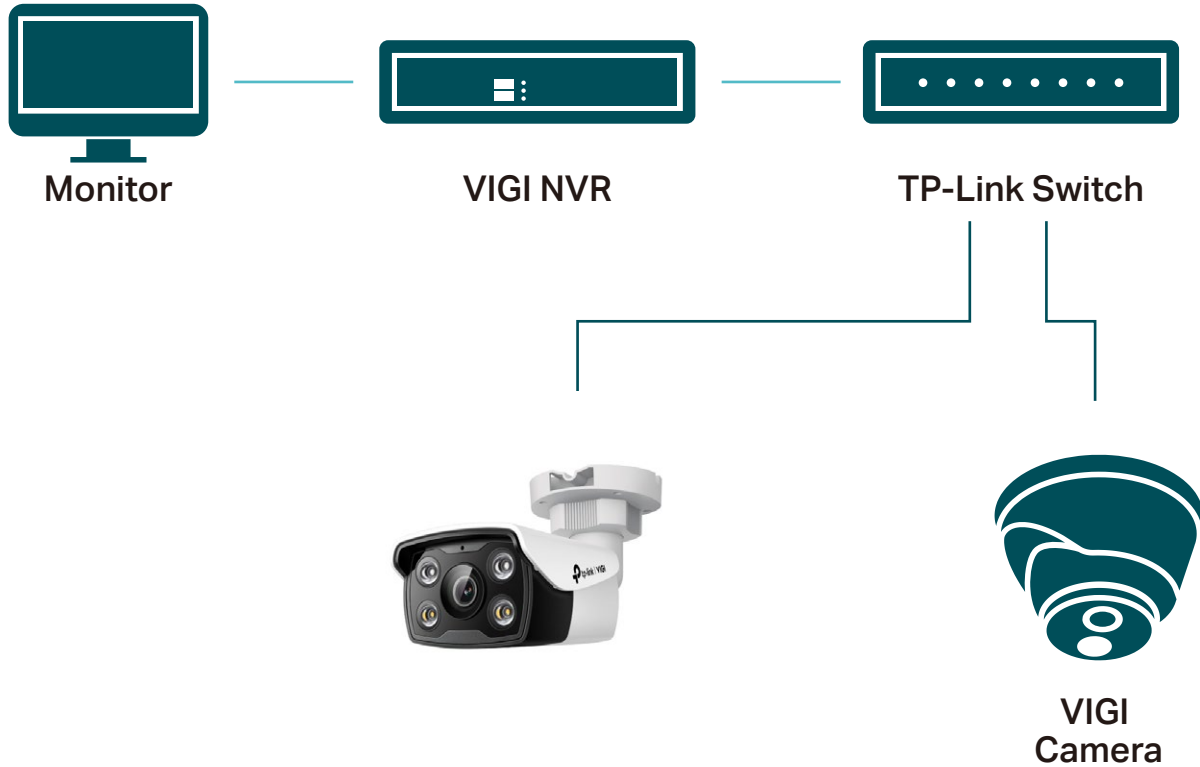

// Flexible Installation

Find the perfect vantage point by simply securing your camera to the ceiling, wall, or pole.

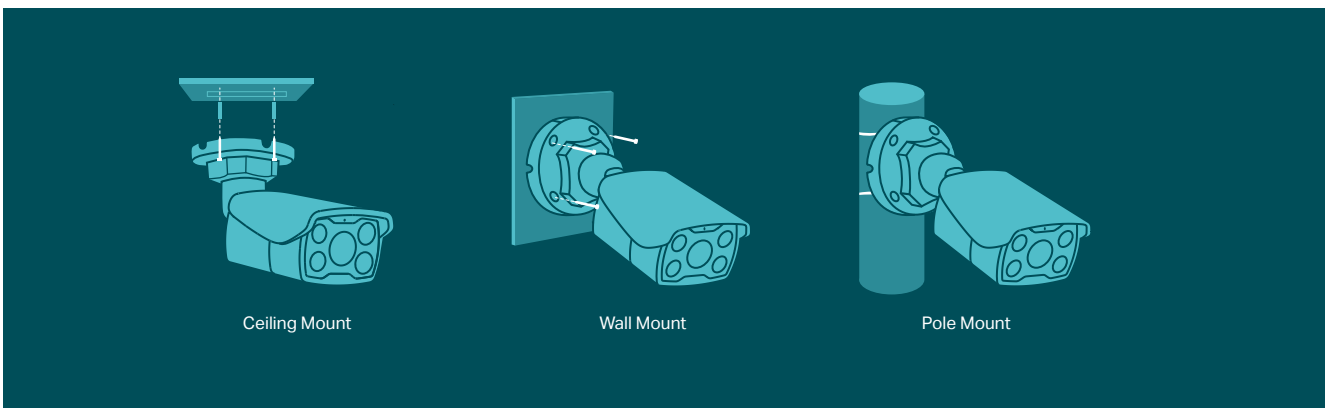

// Specifications

Camera	
Product Model	VIGI C340
Image Sensor	1/3" Progressive Scan CMOS
Shutter Speed	1/3 to 1/10000 s
Slow Shutter	Yes
Min. Illumination	0.005 Lux; 0 Lux with IR/white light
Day/Night Mechanism	IR Cut Filter
Day/Night Switch	Unified/ Scheduled/ Auto
Lens	
Focal Length	Fixed Focal Lens
Focal Length	2.8 mm/4 mm/6 mm
Aperture	2.8 mm: F1.6 4 mm: F1.6 6 mm: F1.6
FOV	<ul style="list-style-type: none">• 2.8mm: Horizontal FOV: 102.5°, Vertical FOV: 55.2°, Diagonal FOV: 122.1°• 4mm: Horizontal FOV: 76.3°, Vertical FOV: 40.6°, Diagonal FOV: 90.2°• 6mm: Horizontal FOV: 50.6°, Vertical FOV: 27.8°, Diagonal FOV: 58.8°
Lens Mount	M12

DORI Distance	<ul style="list-style-type: none"> • 2.8 mm Detect: 64 m (209 ft) Observe: 27 m (87 ft) Recognize: 13 m (42 ft) Identify: 6 m (21 ft) • 4 mm Detect: 80 m (262 ft) Observe: 33 m (109 ft) Recognize: 16 m (52 ft) Identify: 8 m (26 ft) • 6 mm Detect: 128 m (420 ft) Observe: 53 m (175 ft) Recognize: 26 m (84 ft) Identify: 13 m (42 ft)
Angle Adjustment (Manual)	
Range	<ul style="list-style-type: none"> • Pan: 0° to 360° • Tilt: 0° to 90° • Rotation: 0° to 360°
Illuminator	
IR LED	Quantity: 2 Range: 30m Wavelength: 850nm
White LED	Quantity: 2 Range: 30m
Illuminator On/Off Control	Auto/Scheduled/Always on/Always off
Video	
Max. Resolution	2560 X 1440

Main Stream	<ul style="list-style-type: none"> • Frame Rate 50Hz: 1fps, 5fps, 10fps, 15fps, 20fps, 25fps 60Hz: 1fps, 5fps, 10fps, 15fps, 20fps, 25fps, 30fps • Resolution: 2560x1440, 2304x1296, 2048x1280, 1920x1080, 1280x720 <p>Note: If the image rotation is set to 90° or 270°, the frame rate only supports up to 20fps.</p>
Sub-Stream	<ul style="list-style-type: none"> • Frame Rate 50Hz: 1fps, 5fps, 10fps, 15fps, 20fps, 25fps 60Hz: 1fps, 5fps, 10fps, 15fps, 20fps, 25fps, 30fps • Resolution: 640x480, 352x288, 320x240 <p>Note: If the image rotation is set to 90° or 270°, the frame rate only supports up to 20fps.</p>
Bit Rate Control	CBR, VBR
Video Compression	<ul style="list-style-type: none"> • Main Stream: H.265+/H.265/H.264+/H.264 • Sub-Stream: H.265/H.264
H.264 Type	High Profile
H.264+	Main Stream Supported
H.265 Type	Main Profile
H.265+	Main Stream Supported
Video Bit Rate	<ul style="list-style-type: none"> • Main Stream: 256 Kbps to 3 Mbps • Sub-Stream: 64 Kbps to 512 Kbps
Image	
Image Settings	<ul style="list-style-type: none"> • Mirror • Brightness • Contrast • Saturation • Sharpness, Exposure, WDR, • White Balance • Prevent Overexposure to Infrared Light • HLC Adjustable by Client Software • Rotation (90°/270°)
Image Enhancement	BLC/3D DNR/HLC/SmartIR

Wide Dynamic Range	DWDR
SNR	≥ 52 dB
Image Parameters Switch	Yes
Privacy Mask	Up to 4 Masks
ROI	1 Region
OSD Setting	Yes
Audio	
Audio Communication	Two-Way Audio
Audio Input	Yes
Audio Output	Yes
Audio Compression	Yes
Audio Sampling Rate	8KHz
Environment Noise Filtering	Yes
Audio Bit Rate	64 Kbps(G.711 alaw)
Network	
Protocols	TCP/IP, UDP, ICMP, HTTP, HTTPS, DHCP, DNS, RTSP, NTP, UPnP, UDP, SSL/TLS, FTP/SFTP, RTP, IPv4, IPv6, ARP
ONVIF	Yes
API	Open Network Video Interface (Profile S)
Simultaneous Live View	3 Main Streams & 3 Sub-Streams
Client	VIGI App, VIGI Security Manager, Web UI
Web Browser	<ul style="list-style-type: none"> • Google Chrome® 57 and above • Firefox® 52 and above • Safari® 11 and above • Microsoft® Edge 91 and above
Cloud	Yes
Security	Password Protection, HTTPS Encryption, IP Address Filter, Digest Authentication

Alarm and Event Management

Smart Event	<ul style="list-style-type: none">• Human & Vehicle Classification• Intrusion Detection• Line-Crossing Detection• Region Entering Detection• Region Exiting Detection• Object Abandoned/Removal Detection• Scene Change Detection• Abnormal Sound Detection• People Detection• Vehicle Detection• Loitering Detection
Basic Event	<ul style="list-style-type: none">• Motion Detection• Video Tampering Detection• Exception (Illegal Login)
Alarm Linkage	<ul style="list-style-type: none">• Memory Card Video Recording• Message Push• Audible Warning• White Light Flashing• Upload Capture to FTP
Linkage Method	N/A
Output Notification	Message Push
Interface	
Network Interface	1 RJ45 10/100M Self-Adaptive Ethernet Port
On-board Storage	Built-In Memory Card Slot, Support MicroSD Card, up to 512 GB**
Built-in Speaker	Yes
Built-in Microphone	Yes; Records Anything Going on within a 15-ft Radius of the Camera
Audio	N/A
Alarm	N/A
Reset Button	Yes
Power	DC Power Port

General	
Operating Temperature	-30–60 °C
Power Supply	<ul style="list-style-type: none"> • 12V DC \pm 5%, Max. 7 W, 5.5mm Coaxial Power Plug • PoE: 802.3af/at, class 0, Max. 8 W
Protection	IP67 Waterproof
Material	Plastic
Net Weight	0.34 Kg
Gross Weight	0.50 Kg
Product Dimensions	78.5× 188.0 × 71.5 mm (3.09× 7.40× 2.81 in)
Certifications	CE, NTRA, VCCI, BSMI, FCC

Build Features

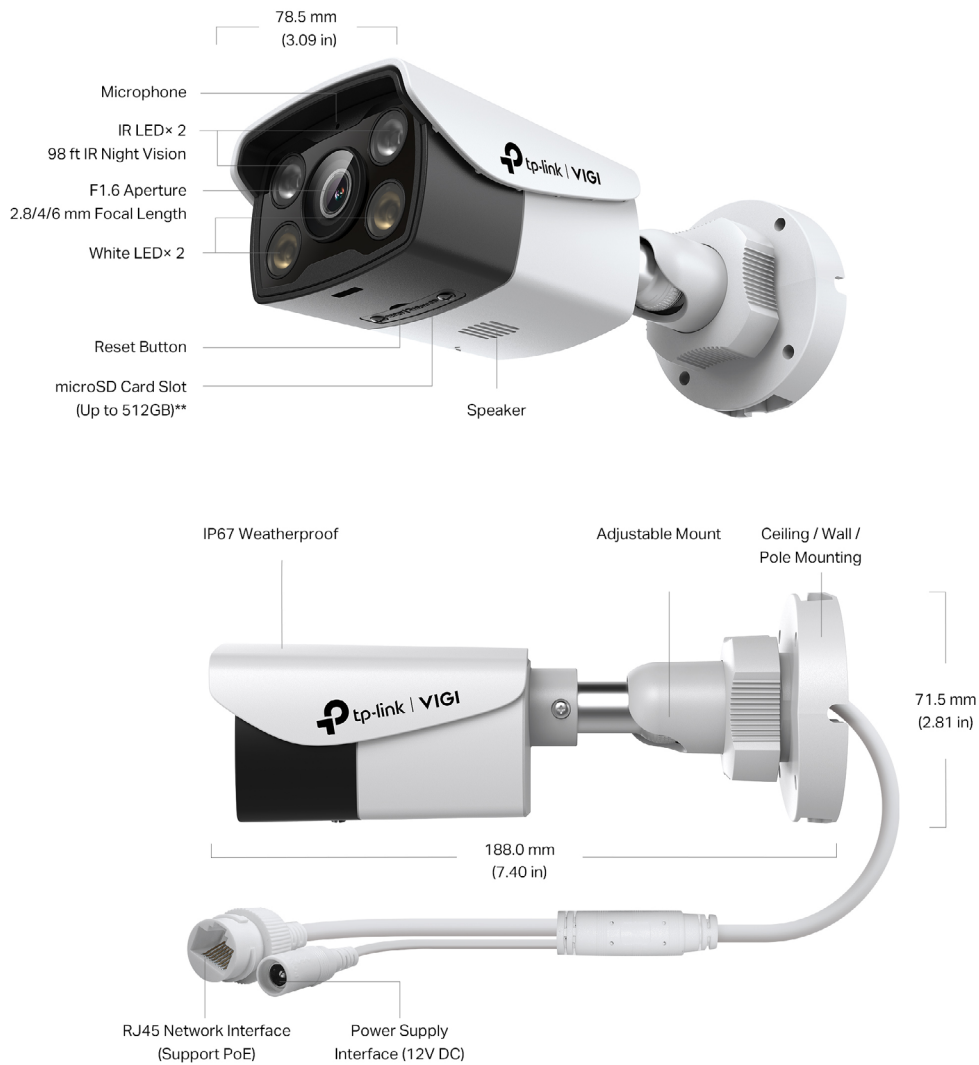

**SD card is not included.

*Micro SD card is not included in the package.

Specifications are subject to change without notice and can be found at www.tp-link.com.

©2024 TP-Link