

# Mini Smart Wi-Fi Plug

Model: Tapo P105

Live Smarter



Remote Control



Schedule & Timer



Voice Control



Easy setup



Away Mode



Flame-retardant\*



## // Highlights

### Remote Control from Anywhere

With Cloud Advantage, instantly turn connected devices on/off wherever you are via the Tapo app. Designed to facilitate your life and help eliminate potential safety hazards.

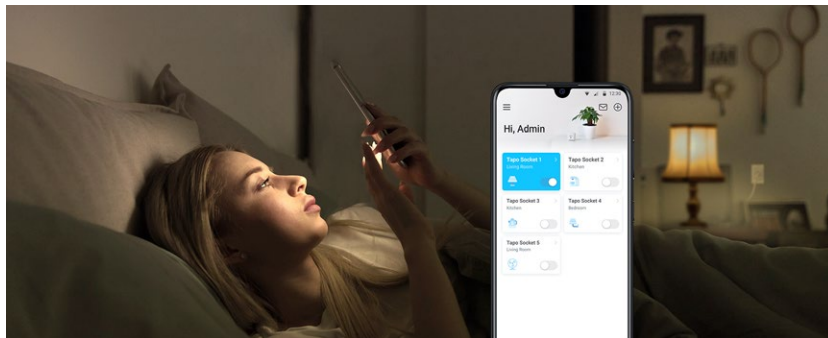

### Live Smarter by Presetting Time

Schedule and Timer features allow you to create weekly schedule and countdown plans. All of your connected electronics will automatically work at your preset time, making your life smart, convenient, and energy-saving.

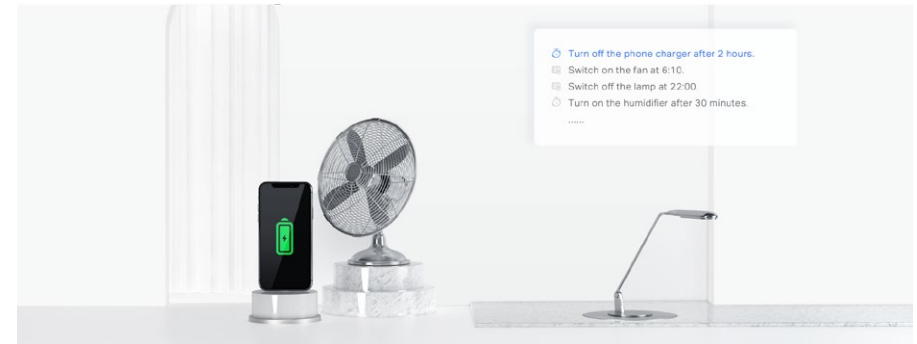

## // Highlights

### A Deterrent for Your Home

Away Mode, a feature that intelligently simulates someone being home by turning the plugged in device (like a lamp) on and off, makes it appear that someone is home when you're on long trips to keep away people with ill intent.

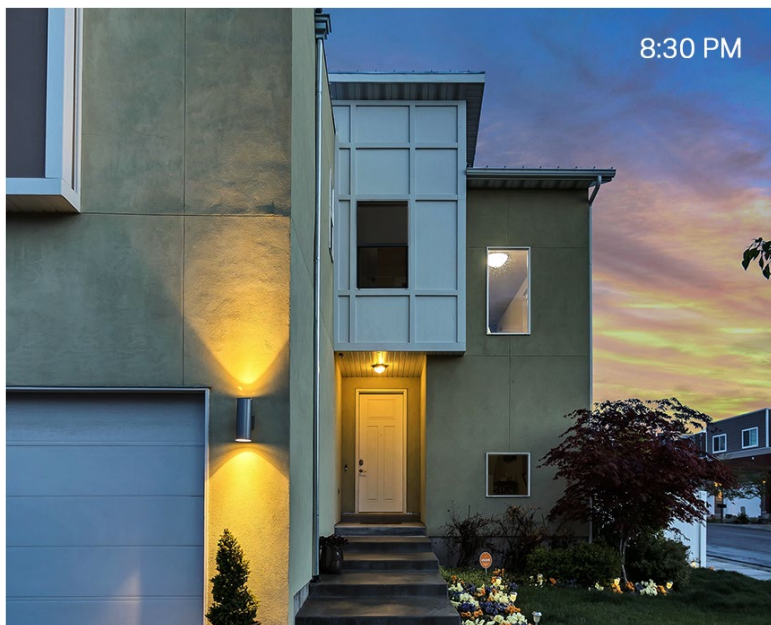

### Free Up Your Hands with Voice Control

You can use Amazon Alexa or Google Assistant to control your devices with voice commands like "Alexa, turn on the toaster please".

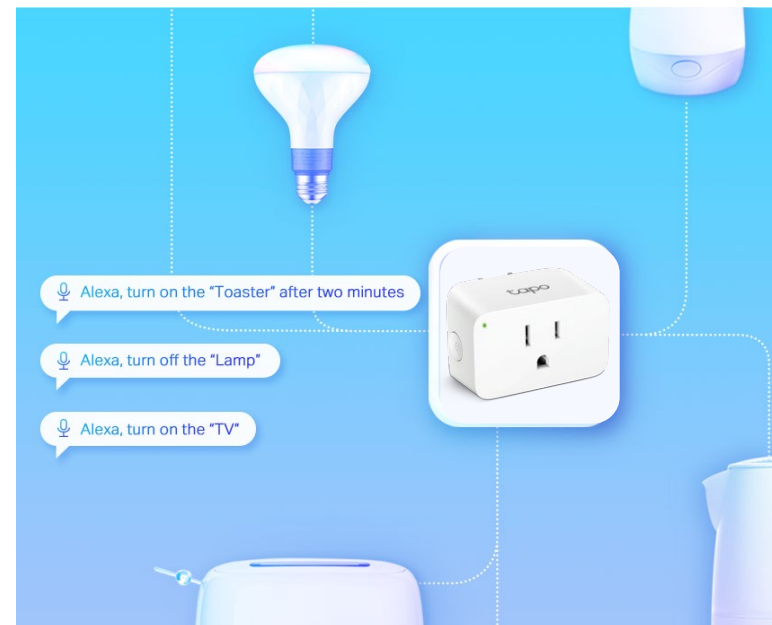

\*No separate hub and accessories are required.

## // Features

- **Remote Control** – Instantly turn connected devices on/off wherever you are through the Tapo app.
- **Schedule** – Preset a schedule to automatically manage devices.
- **Timer** - Create countdown timer lists for connected electronics.
- **Voice Control** – Manage your smart socket with voice commands via Amazon Alexa or the Google Assistant.
- **Away Mode** – Automatically turns devices on and off at different times to give the appearance that someone is home.
- **Compact Design** - Mini-sized to avoid blocking adjacent sockets.
- **Easy Setup and Use** - No hub required, set up quickly and manage easily through the free app. Bluetooth onboarding technology makes setup simpler for faster connection.
- **Device Sharing** - Easily share management permissions with each member of your family.
- **Flame-Retardant\*** - PC flame-retardant materials help minimize burning hazards.

\*Made with V-0 (UL94) flame-retardant materials.

## // Specifications

### General

- LED&Button: Status LED, Power Button
- Material: PC
- Power Supply: AC, 100-125 V, 50/60 Hz 15 A
- Max Load: 1800 W, 15 A
- Protocol: IEEE 802.11b/g/n, Bluetooth 4.2 (for onboarding only)
- Wireless Type: 2.4 GHz
- System Requirements: Android 4.4 or higher, iOS 9.0 or higher

### Others

- Package Contents:  
Mini Smart Wi-Fi Plug Tapo P105  
Quick Start Guide
- Certifications: FCC, RoHS
- Operating Temperature: 0 °C– 40 °C (32°F–104°F)
- Operating Humidity: 10%–90%RH, Non-condensing
- Dimensions : 2.4\* 1.5\* 1.3 in (60\*38\*33 mm)

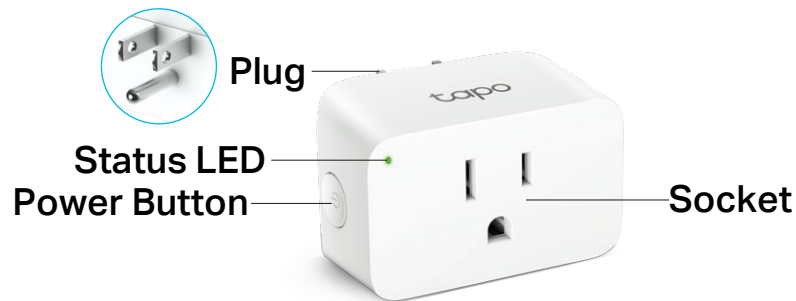

\*Made with V-0 (UL94) flame-retardant material.

\*Bluetooth is only used for onboarding.

\*The total power of the connected electrical equipment should not exceed the max load current (15 A).

\*Please do not use in damp environments or outdoors.

For more information, please visit <https://www.tapo.com/>

Specifications are subject to change without notice. TP-Link is a registered trademark of TP-Link Technologies Co., Ltd. App store is a service mark of Apple Inc. Google is a trademark of Google LLC. Amazon, Alexa, and all related logos are trademarks of Amazon.com, Inc. or its affiliates. Other brands and product names are trademarks or registered trademarks of their respective holders. Copyright ©2020 TP-Link Technologies Co., Ltd. All rights reserved.