



* All images in this datasheet are for illustrative purposes only.

Indoor LED GSCE

Ceiling LED Display for Virtual Production

 Easy Installation and Maintenance

 Front or Rear Serviceability

 High Brightness

 Power UI/UX with Megapixel VR HELIOS LED Processing Platform

GSCE

Pixel Pitch 3.91 mm

Brightness 5,000 nit

Weight per Cabinet 1.4 kg/Cabinet

Service Access Front or Rear (Select One Only)

IP Rating Front / Rear IP30 / IP30



Fast Installation

Various factors including magnets on the top and bottom, positioning pins, handles and fast locks help installers easily set up and dismantle the LED screens without additional tools.

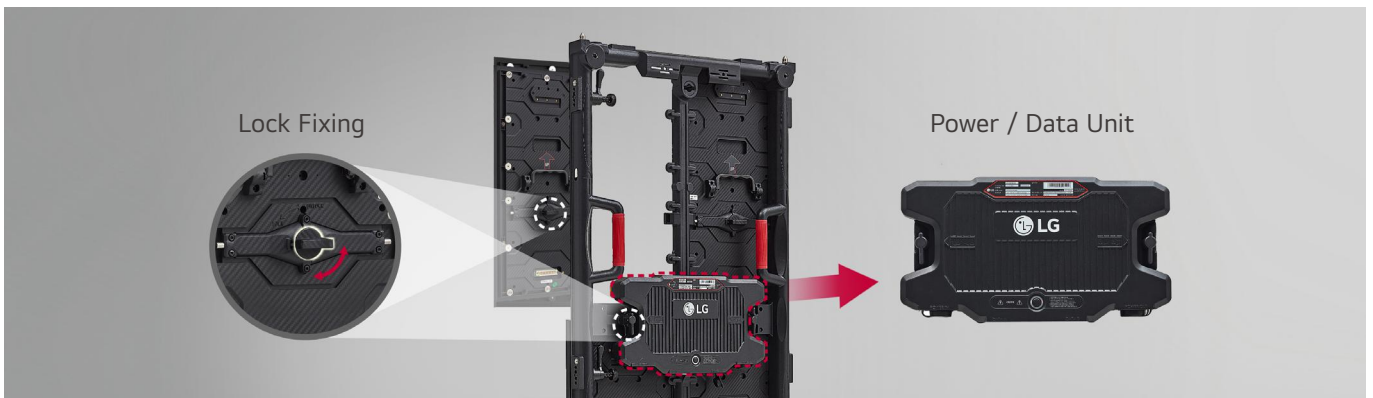

Easy Maintenance

The GSCE series applied a simple Lock Fixing method which requires no additional tools, making it easier to replace LED modules or power/data units. It saves cost and time for maintenance.

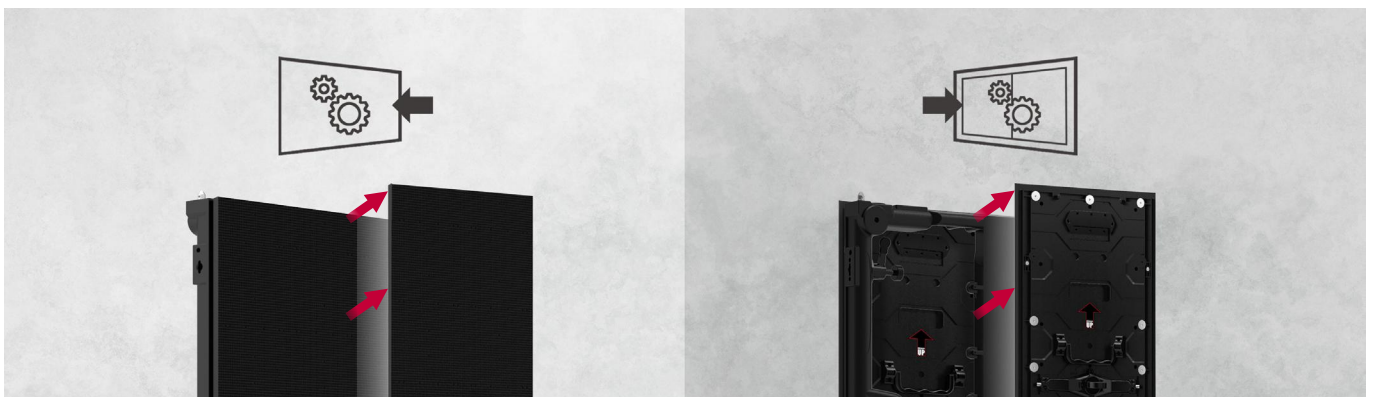

Front or Rear Serviceability

The product offers either front access or rear access, allowing customers to choose installation options according to their environment and minimizes limitations in installation and maintenance.

Approx. 400 SQM



Approx. 50 ~ 100 SQM

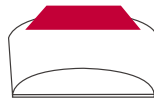

Approx. 20 ~ 50 SQM

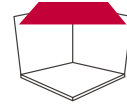

High Brightness

The ceiling LED with 5,000 nits enables GSCE series to be used for alternative lightings in XR and virtual production.

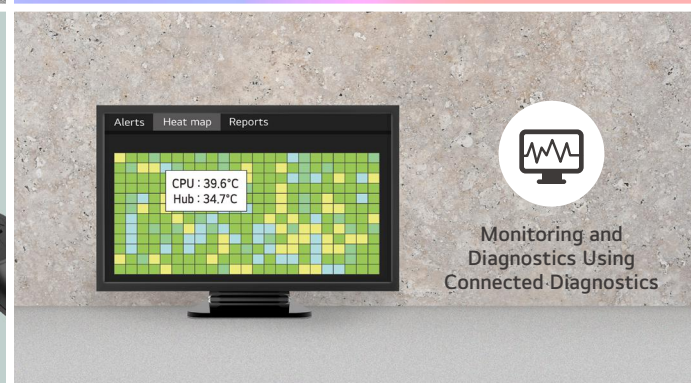
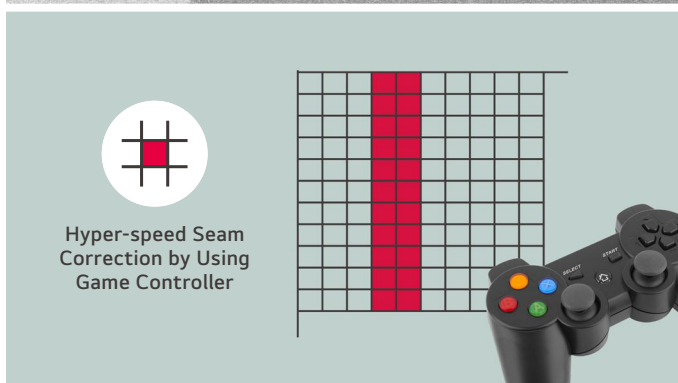
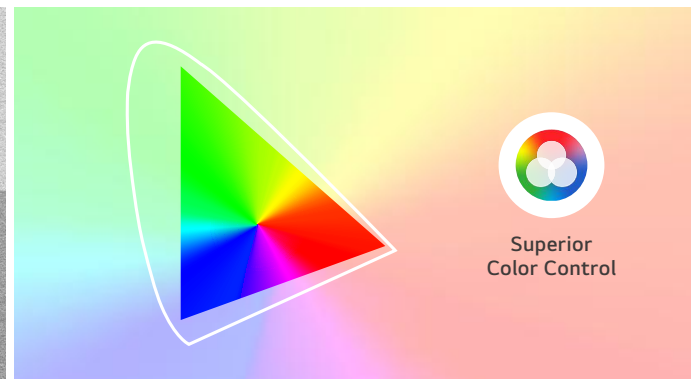
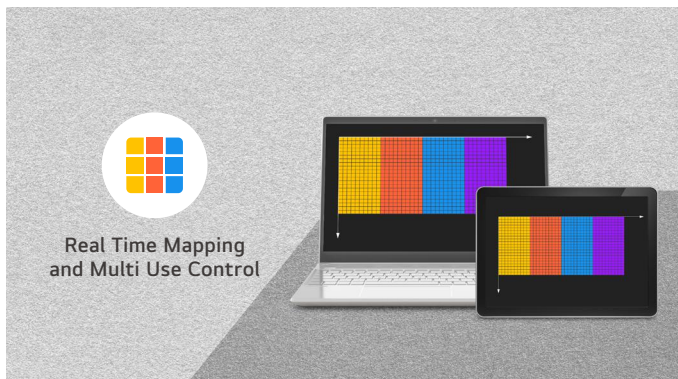

Powerful UI/UX with Megapixel VR HELIOS LED Processing Platform

Thanks to the compatibility between GSCE and the Megapixel VR HELIOS LED processing platform, you can now utilize the powerful UX and UI functionalities offered by HELIOS. HELIOS processing platform includes Real-Time Mapping and Multi-User Control, Superior Color Control, Hyper-Speed Seam Correction using a game controller, and Monitoring and Diagnostics through connected diagnostics.

* Please note that Megapixel VR HELIOS LED processing platform needs to be purchased separately, and depending on the actual usage environment, there may be limitations in the implementation of certain features offered by HELIOS. A game controller needs to be purchased separately.

SPECIFICATIONS

GSCE039-GN

Pitch Name		P3.91
Physical Parameters	Pixel Configuration	Single SMD
	Pixel Pitch (mm)	3.91
	Module Resolution (W × H)	64 × 128
	Module Dimensions (W × H, mm)	250 × 500
	Weight per Module (kg)	1.4
	No. of Modules per Cabinet (W × H)	2 × 2
	Cabinet Resolution (W × H)	128 × 256
	Cabinet Dimensions (W × H × D, mm)	500 × 1,000 × 66.05
	Cabinet Surface Area (m ²)	0.5
	Weight per Cabinet (kg/Cabinet)	12.4
	Weight per Square Meter (kg/m ²)	24.9
	Physical Pixel Density (pixels/m ²)	65,536
	Flatness of Cabinet (mm)	±0.3
	Cabinet material	Die-casting Magnesium
Service Access	Front or Rear (Select One Only)	
Optical Specifications	Max. Brightness (After Calibration, nit)	5,000
	Color Temperature (K)	2,000-11,000
	Visual Viewing Angle (H × V)	160 × 155
	Brightness Uniformity	0.97
	Color Uniformity	±0.003 Cx, Cy
	Contrast Ratio	6,000 : 1
	Processing Depth (bit)	16 (PQ, HLG)
Electrical Specifications	Power Consumption (W/Cabinet, Max.)	300
	Power Consumption (W/Cabinet, Avg.)	100
	Power Consumption (W/m ² , Max.)	600
	Heat Dissipation (BTU/h/Cabinet, Max.)	1,024
	Heat Dissipation (BTU/h/Cabinet, Avg.)	341
	Heat Dissipation (BTU/h/m ² , Max.)	2,047
	Power Supply (V)	100 to 240
	Frame Rate (Hz)	50 / 60
Refresh Rate (Hz)	3,840	
Operation Specifications	Lifetime (Half Brightness)	100,000
	Operating Temperature (°C)	-30 to +45
	Operating Humidity	10-99% RH
	IP Rating Front / Rear	IP30 / IP30
Standard	Certification	CE, FCC, ETL
	Environment	RoHS
Controller		Megapixel VR HELIOS LED Processing Platform
90 Degree Corner Cut		No

Megapixel VR HELIOS LED Processing Platform (Controller)

Cabinet		GSCE
Max Output Range	Loading Capacity	8,192 × 4,320 @ 60 Hz
	Output Resolution	35.3 Million Pixels
Input	HDMI 2.0, HDCP 2.2, DP 1.4 (HBR3), SDI (4 × 12G-SDI), OPS (ST2110)	
Output	Optic (To LED Screen (8 × 10G))	
Control	LAN	Yes
	GenLock	Yes (In)
Video Processing	Brightness Adjustment, Chroma Adjustment, Improved Grayscale at Low Brightness, Scaling, HDR (PQ, HLG, Custom), EDID Custom	
Application	SuperSign CMS (Cross-platform Web Interface), webOS API, Configuration SW (Cross-platform Web Interface)	
Mechanical	Size (W × H × D, mm)	481.5 × 44.2 × 393
	Weight (kg)	5.7

* Specifications are subject to change without notice. Please make sure to check the product manual for details about product usage.



Download
LG C-Display+
Mobile App
Google Play Store

www.lg.com/global/business/information-display
www.youtube.com/c/LGCommercialDisplay
www.facebook.com/LGInformationDisplay
www.linkedin.com/company/LGinformationdisplay
twitter.com/LG_ID_HQ

LG may make changes to specifications and product descriptions without notice. Copyright © 2024 LG Electronics Inc. All rights reserved. "LG Life's Good" is a registered trademark of LG Corp. The names of products and brands mentioned here may be the trademarks of their respective owners.