

PN16 CAST BRONZE Y TYPE STRAINER

SCREWED CAP / Y PATTERN

Figure PN16-BTE

Max. Service Pressure 25bar at 100°C / 10.5bar at 186°C

Note(s) Please refer to Drawing for applicable standard and other detail information.

Dimensions (UNIT : mm)

NOMINAL SIZE		L	H	H1	A	B
NPS	DN					
1/2	15	65	42	56	1.0	1.5
3/4	20	80	52	72	1.0	1.5
1	25	92	60	89	1.0	1.5
1 1/4	32	110	72	107	1.0	1.5
1 1/2	40	122	81	121	1.0	1.5
2	50	150	101	147	1.0	1.5



Materials

NAME OF PART	MATERIAL
BODY	CAST BRONZE
CAP	FORGED BRASS
SCREEN	STAINLESS STEEL

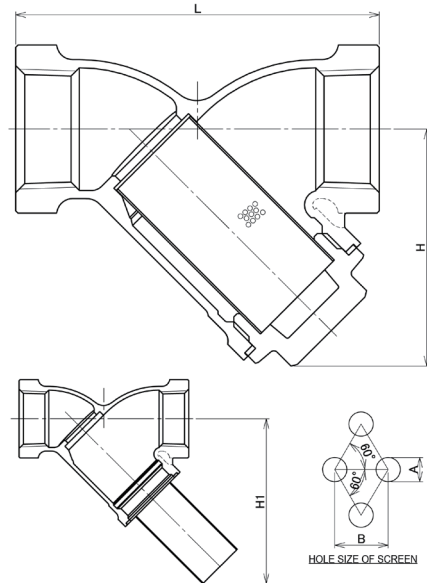

*Design and materials are subject to change without notice.