

View A

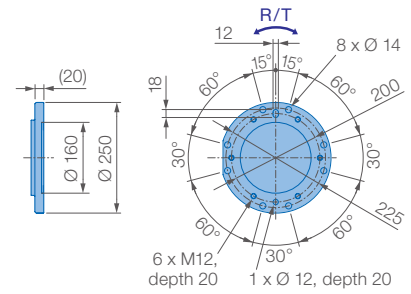

View B

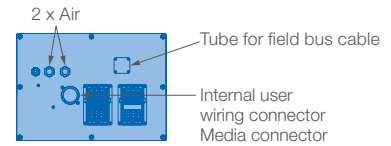

View C

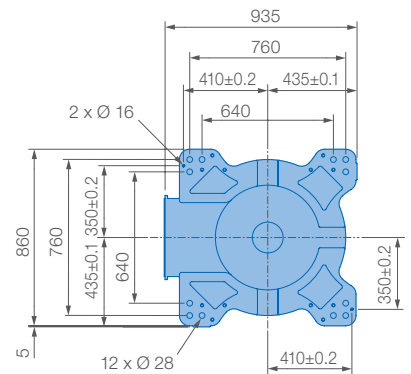

Mounting option: Shelf-mounted
Protection class: IP54/67

View D

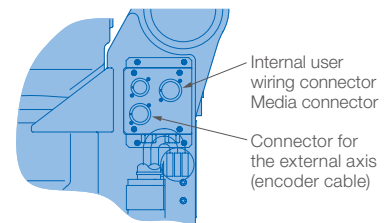

Allowable wrist load

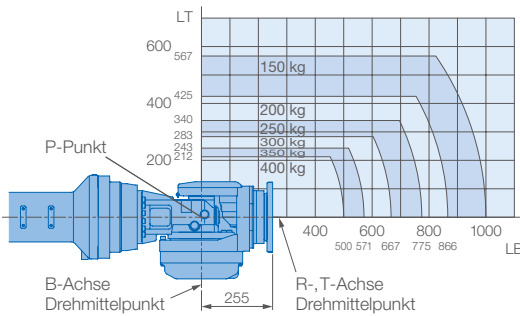

Specifications GP400R						
Axes	Maximum motion range [°]	Maximum speed [°/s]	Allowable moment [Nm]	Allowable moment of inertia [kg · m²]	Controlled axes	6
					Max. payload [kg]	400
S	±150	80	–	–	Repeatability [mm]	±0.1
L	+20/–122	80	–	–	Max. working range R [mm]	3518
U	+120/–9	80	–	–	Temperature [°C]	0 to +45
R	±360	80	1960	150	Humidity [%]	20 – 80
B	±120	80	1960	150	Weight [kg]	3560
T	±360	160	833	50	Power supply, average [kVA]	7,0