

View A

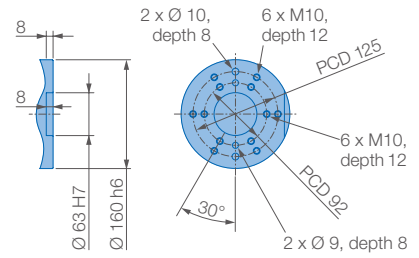

View B

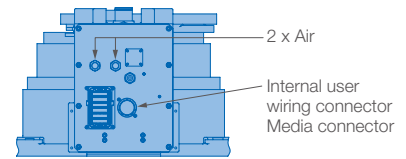

View C

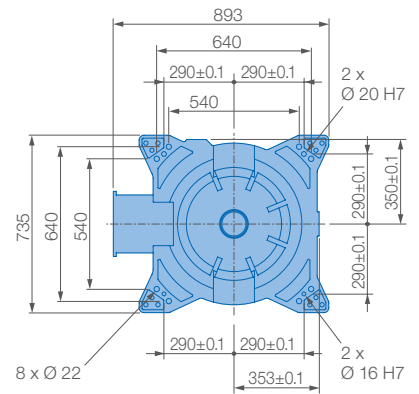

Mounting option: Shelf-mounted
Protection class: IP54/67

View D

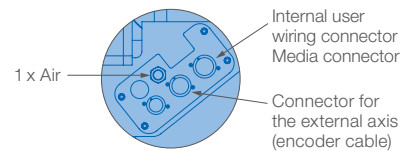

Allowable wrist load

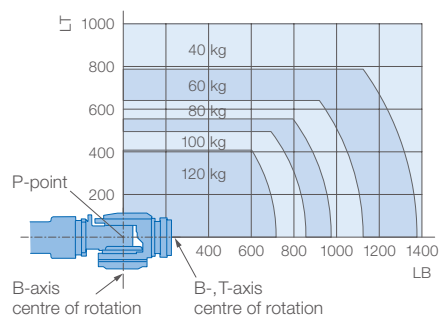

Specifications GP120RL						
Axes	Maximum motion range [°]	Maximum speed [°/s]	Allowable moment [Nm]	Allowable moment of inertia [kg · m²]	Controlled axes	6
S	±180	90	–	–	Max. payload [kg]	120
L	+80/–130	85	–	–	Repeatability [mm]	±0.2
U	+90/–78.4	85	–	–	Max. working range R [mm]	4004
R	±360	175	833	75	Temperature [°C]	0 to +45
B	±130	150	833	75	Humidity [%]	20 – 80
T	±360	240	490	25	Weight [kg]	1830
					Power supply, average [kVA]	5