

## Stainless Steel Ball Valve, With High Mounting Pad, JIS10K

Model : SMBA-F104, SMBA-F116

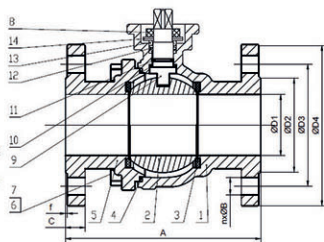
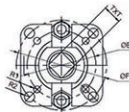
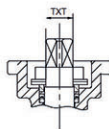
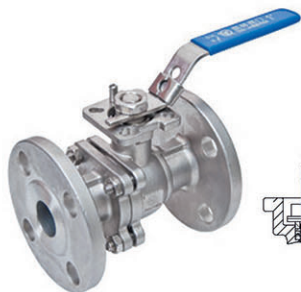

### Specification Standards :

- Basic design and manufacture according to JIS B2071
- Inspection and tested according to JIS B2003
- Face to face according to JIS B2002
- Flange end according to JIS B2212

### Features :

- 2-pieces body design, full port
- Lever handle operation
- Available upon special request
- Come with ISO High Mounting Pad 5211

### Application :

- For general and industrial services
- Applicable medium : water, oil, gas

### Materials :

No.	Description	Material
1	Body	CF8 / CF8M
2	Ball	CF8 / CF8M
3	Seat	PTFE
4	Gasket	PTFE
5	Cap	CF8 / CF8M
6	Bolt	SS304
7	Nut	SS304
8	Gland	SS316 / SS304
9	Stem	SS316 / SS304
10	Thrust washer	PTFE
11	O-ring	Viton
12	Stem packing	PTFE
13	Washer	SS304
14	Belleville washer	SS304

### Test Requirements

Working Pressure	150 PSI ( 10 Bar )
Maximum Pressure	200 PSI ( 14 Bar )
Shell Test Pressure	300 PSI ( 21 Bar )
Applicable Temperature	≤ 150 °C

### Dimensions

mm

Size	1/2"	3/4"	1"	1-1/4"	1-1/2"	2"	2-1/2"	3"	4"	5"
A	108	117	127	140	165	178	190	203	229	356
C	12	14	14	16	16	16	18	18	18	20
D1	15	20	25	32	40	50	65	80	100	125
D2	51	56	67	76	81	96	116	126	151	182
D3	70	75	90	100	105	120	140	150	175	210
D4	95	100	125	135	140	155	175	185	210	250
E	36	36	42	42	50	50	70	70	70	102
F	42	42	50	50	70	70	102	102	102	125
f	1	1	1	2	2	2	2	2	2	2
nxØB	4-15	4-15	4-19	4-19	4-19	4-19	4-19	8-19	8-19	8-23
R1	6	6	6	6	8	8	10	10	10	12
R2	6	6	8	8	10	10	12	12	12	14
T X T	9X9	9X9	11X11	11X11	14X14	14X14	17X17	17X17	19X19	22X22