

4K H.265 Pro NVR 8000 Series



DATASHEET

4K	H.265 HEVC	Onvif S&T	N+1 Hot Spare	Multi-video Output	Transcoding	RAID
ANPR	VCA	Online Upgrade	P2P	HTML5	ANR	Face Detection

KEY FEATURES

- ▶ 32/64-CH Network Video Input (Up to 32/64 channel IP cameras can be connected.)
- ▶ H.265⁺ (H.265⁺ allows to cut down 70%~80% bandwidth while ensuring the high quality of images compared with H.264.)
- ▶ HTML5 Streaming Ready (Support previewing the video via all major browsers without plug-in when Video Codec is set to H.265.)
- ▶ Transcoding (Transcoding guarantees fluid video experience by reducing the stream data via lowering resolution, bit rate, or frame rate.)
- ▶ Auto Backup (The latest 24 hours' video will be automatically backed up to USB Port Devices/NAS/eSATA after setting up the backup.)
- ▶ Versatile Interfaces (A whole array of ports provides all necessary features for effective surveillance.)

Power Decoding Capacity & Flexible Storage Options

- The 4K NVR is equipped with solid 4K decoding and display capabilities and maximum supports simultaneous viewing of 16*1080P or 32*720P network cameras.
- Providing flexible storage options including HDD, eSATA and NAS to address the needs for versatile storage.

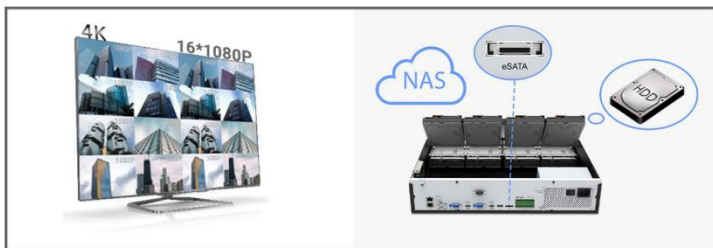

AI Video Analytics & POS Integration

- All-in-one to Manage AI & ANPR: VCA Function focus on human and vehicle detection. People Counting provides high-accuracy data and statistic reports. Face Detection function supports attribute recognition. Enterprise ANPR Management makes it easy to monitor traffic.
- POS machine information can be transferred to and displayed on the NVR.

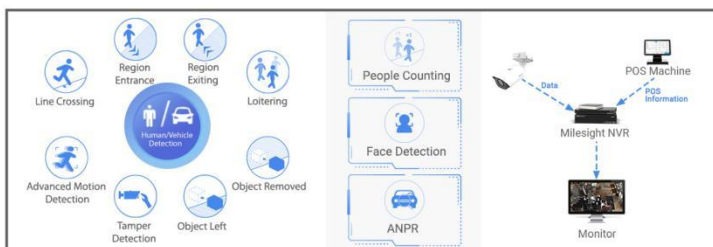

Reliability and Usability

- RAID improves the disk reliability to ensure the recording security.
- ANR can store video data on the camera storage card when network between IPC and NVR is disconnected and retransfer the recorded video to NVR after network recovers.
- N+1 Hot Spare can keep the system working on and ensure the data integrity and reliability.

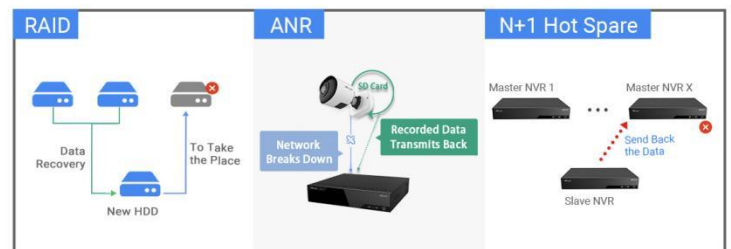

Flexible Structure Options

- Multi-video Output in two ways: Independent Outputs and Synchronous Outputs
- Dual network ports provide three network working modes for more independence, and higher throughput and stability according to the specific applications and needs.

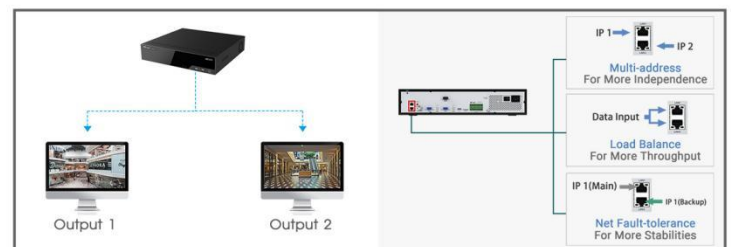



Model			MS-N8032-UH	MS-N8064-UH
Video/Audio Input	Network Video Input		32-CH	
	Bandwidth	Incoming	256Mbps or 200Mbps(when RAID is enabled)	320Mbps or 200Mbps(when RAID is enabled)
		Outgoing	256Mbps or 200Mbps(when RAID is enabled)	256Mbps or 200Mbps(when RAID is enabled)
Video/Audio Output	HDMI Output		2-CH, Resolution: 3840x2160/60Hz(HDMI1 Only), 3840x2160/30Hz(HDMI1 Only), 1920x1080/60Hz, 1920x1080/50Hz, 1280x1024/60Hz, 1280x720/60Hz, 1024x768/60Hz HDMI Supports Audio Output	
	VGA Output		2-CH, Resolution: 1920x1080/60Hz, 1920x1080/50Hz, 1280x1024/60Hz, 1280x720/60Hz, 1024x768/60Hz	
	Dual Stream		Support	
	Recording Resolution		12MP/8MP/6MP/5MP/4MP/3MP/1080P/UXGA/720P/D1/VGA/CIF/QCIF	
	Synchronous Playback		4*(30fps @8MP), 5*(30fps @6MP), 6*(30fps @5MP), 8*(30fps @4MP), 10*(30fps@3MP), 16*(30fps@1080P), 32*(30fps@720P)	4*(30fps @8MP), 5*(30fps @6MP), 6*(30fps @5MP), 8*(30fps @4MP), 10*(30fps@3MP), 16*(30fps@1080P), 32*(30fps@720P), 64*(30fps @D1)
Video/Audio Compression	Video Compression		H.265*/H.265(HEVC)/H.264*/H.264	
	Audio Compression		G.711/AAC/G.722/G.726	
	Sample Rate		8KHz/16KHz	
Storage	SATA		8*SATA HDD (3.5")	
	eSATA		1*eSATA	
	Capacity		Up to 10TB capacity for each HDD	
Disk Array	Array Type		RAID0, RAID1, RAID5, RAID6, RAID10	
Recording Management	Recording Type		Continuous, Event (Motion Detection, Alarm, VCA, Smart Analysis)	
	Snapshot Type		Continuous, Event (Motion Detection, Alarm, VCA, Smart Analysis)	
	Playback Type		General Playback, Event Playback, Tag Playback, Split Playback, Picture Playback	
Backup	Backup		Video Backup, Image Backup	
Network	Protocol		IPv4/IPv6, TCP, UDP, RTP, RTSP, RTCP, HTTP, HTTPS, DNS, DDNS, DHCP, NTP, SNTP, SMTP, SNMP, UPnP, NFS	
External Interface	Network Interface		2*RJ45 10/100/1000Mbps	
	Serial Interface		1*RS-485 Series Port for PTZ	1*RS-232 Series Port for Console
			1*RS-485 Series Port for Keyboard	
	USB Interface		1*USB 3.0; 2*USB 2.0	
	Audio Input/Output		1*RCA/2*RCA	
	Alarm Input/Output		16-CH/4-CH	
General	Compatibility		ONVIF, API	
	Advanced Function		ANR, N+1 Hot Spare	
	ANPR		Support	
	Video Analysis		Region Entrance, Region Exiting, Advanced Motion Detection, Tamper Detection, Line Crossing, Loitering, Human Detection, People Counting, Object Left, Object Removed	
	Keyboard Control		Milesight Keyboard (MS-K01)	
	Power Supply		AC 100V~240V 50Hz~60Hz	
	Consumption		≤35W(Without HDD)	
	Working Conditions		Temperature: -10℃~55℃/Humidity: 10%~90%	
	Dimensions		Rack Mountable Chassis (2.0U Standard) 440mm(W)X420mm(D)X88.2mm(H)	
	Weight		6.0Kg	
Warranty		3/5 Years		

4K H.265 Pro NVR 8000 Series



Interfaces

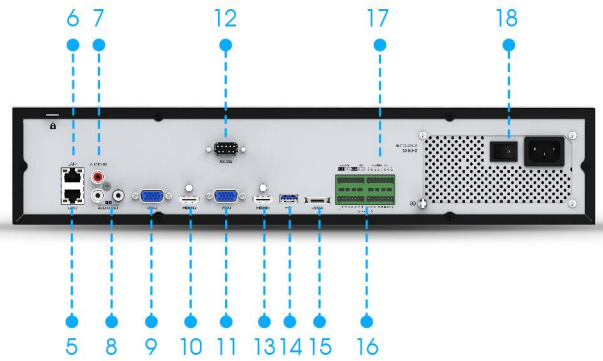
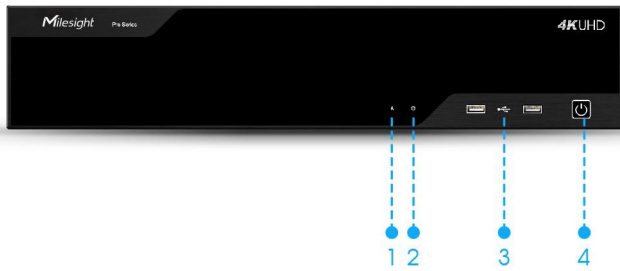

- 1. Run Indicator 2. HDD Indicator 3. USB 4. Power
- 5. LAN1 6. LAN2 7. Audio In 8. Audio Out
- 9. VGA2 10. HDMI2 11. VGA1 12. RS-232
- 13. HDMI1 14. USB 15. eSATA 16. Alarm In
- 17. Alarm Out 18. Power

Installation of HDDs



Step1



Step2



Step3



Step4



Step5

Structure Diagrams

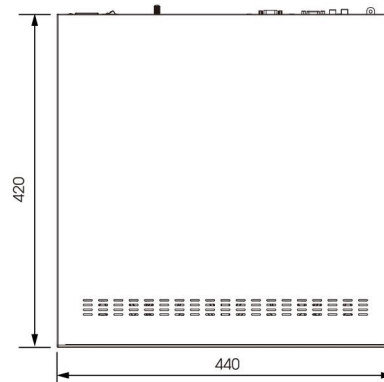

Units: mm

Naming Convention



Milesight | www.milesight.com

Contact Us: sales@milesight.com support@milesight.com

Add: 220 NE 51st Street, Oakland Park, Florida 33334, USA
Tel: +1-800-561-0485

Add: 925, Anyang SK V1 Center, LS-ro 116beon-gil, Dongan-gu, Anvang-si, Korea
Tel: +82-31-990-7732

Add: Building C09, Software Park Phase III, Xiamen 361024, Fujian, China
Tel: +86-592-5922772

