

Control Station and Control Panel: Panel Mounted Operating Devices and Windows, IIC

Flameproof and Dust protection by enclosure

Zone 1 & 2 – 21 & 22



Application

The panel mounted operating devices are designed for used with the flameproof enclosure and dust protection enclosure for controlling or indicating the status of electrical equipment such as motor starter, control equipment operation. They are suitable for Zone 1, 2 and Zone 21, 22 hazardous areas.

Technical Data

Hazardous Area		Gas	Dust
Zones		1 & 2	21 & 22
Equipment Group/Category		Ex II 2G	Ex II 2D
Symbol of Protection	DPL1, DPB1, DPBS1, DMPB1, ASPB1, DSL1 & DSLK1 series ACM1, ACM2, ALCB1, ALCB2 & DCM1 series ALCB3 series LGCR, LGCR1 & LGCS series	Ex db IIC Gb Ex db IIB Gb Ex db IIB+H2 Gb	Ex tb IIIC Db
Certificate No.	TÜV CY 17 ATEX 0205880U		
Conformity to Standards	EN 60079-0:2012/A11:2013, EN 60079-1:2014, EN 60079-31:2014		
Ambient Temperature	-20°C to +55°C	Index of Protection	IP66

Specification

Thread coupling, Shaft :
Stainless steel, SUS 304
(optional SUS 316)
Thread bushing : Aluminium
Lock nut : Nickel-plated
brass
Flush button : Plastic
O-ring : Neoprene

Electrical Rating

Pilot lights characteristics				
Current consumption	For all colours	24V.dc/ ac	20mA. (27 max)	
		120V.ac	18mA. (21 max)	
		230-240V.ac	16mA. (20 max)	
Voltage limit	At nominal voltage	24V.dc	19.2-30V.dc	
		24V.ac	26.1-26.4V.ac	
		120V.ac	100-132V.ac	
		230-240V.ac	195-264V.ac	
Service life	At nominal voltage and at an ambient temp. of 25°C	70,000Hrs.		

Contact Block ratings				
Rated operational current (EN/IEC 60947-5-1)	AC15	240V.	3A.	
		600V.	1.2A.	
	DC13	250V.	0.27A.	
600V.		0.1A.		
Rated thermal current		10A.		
Rated insulation voltage		600V.		

Cam operated switches				
Rated operational current (EN/IEC 60947-3)	16A.	25A.	32A.	
	20A.	30A.	40A.	
	400V.	400V.	600V.	

DPL1 series Page D8/77	DPB1 series Page D8/77	DPBS1 series Page D9/77	DMPB1 series Page D9/77
ASPB1 series Page D9/77	DSL1 series Page D10/77	DSLK1 series Page D10/77	ACM1 series Page D11/77
ACM2 series Page D11/77	DCM1 series Page D11/77	ALCB1 series Page D12/77	ALCB2 series Page D12/77
ALCB3 series Page D12/77	LGCR series Page D12/77	LGCR1 series Page D12/77	LGCS series Page D12/77

Control Station and Control Panel: Panel Mounted Operating Devices and Windows, IIC

Flameproof and Dust protection by enclosure

Zone 1 & 2 – 21 & 22

Pilot Light, DPL1 series



Dimension in mm.

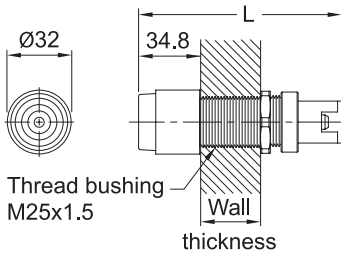

Wall thickness of enclosure (□)	Length (L)
A (15-30mm.)	99.0
B (31-45mm.)	119.0

Push Button, DPB1 series



Dimension in mm.

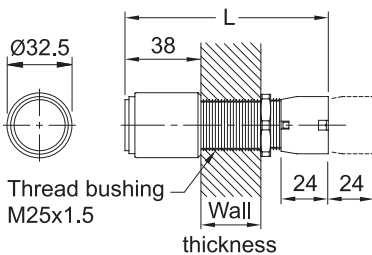

Wall thickness of enclosure (□)	Length (L)
A (15-30mm.)	96.0
B (31-45mm.)	116.0

Catalogue Number Logic

DPL1 - □ ■ ■ ■ ■

Series	Wall thickness of enclosure	Voltage	Colour of lens
A	15-30 mm.	D02 24V.dc	G Green B Blue
B	31-45 mm.	D11 110V.dc	R Red C Clear
		A12 120V.ac	Y Yellow
		A22 220-230V.ac	

Ordering Requirements

Operating Voltage	Diagram (Integral LED)	Colour of Lens	Cat. No.	Approx. Weight (kgs.)
24V.dc/ ac ~	X1 ⊗ X2	Green ●	DPL1-□ D02G	0.145
		Red ●	DPL1-□ D02R	
		Yellow ●	DPL1-□ D02Y	
		Blue ●	DPL1-□ D02B	
		Clear ●	DPL1-□ D02C	
110V.dc * —	X1 ⊗ X2	Green ●	DPL1-□ D11G	0.145
		Red ●	DPL1-□ D11R	
		Yellow ●	DPL1-□ D11Y	
		Blue ●	DPL1-□ D11B	
		Clear ●	DPL1-□ D11C	
120V.ac ~	X1 ⊗ X2	Green ●	DPL1-□ A12G	0.145
		Red ●	DPL1-□ A12R	
		Yellow ●	DPL1-□ A12Y	
		Blue ●	DPL1-□ A12B	
		Clear ●	DPL1-□ A12C	
220-230V.ac 50/60Hz. ~	X1 ⊗ X2	Green ●	DPL1-□ A22G	0.145
		Red ●	DPL1-□ A22R	
		Yellow ●	DPL1-□ A22Y	
		Blue ●	DPL1-□ A22B	
		Clear ●	DPL1-□ A22C	

* Factory cert.

Catalogue Number Logic

DPB1 - □ ■ ■ ■ ■

Series	Wall thickness of enclosure	Contact	Colour of button
A	15-30 mm.	10 1NO 20 2NO	G Green B Black
B	31-45 mm.	01 1NC 02 2NC	R Red W White
		11 1NO-1NC	Y Yellow

Ordering Requirements

Type of Function	Contact Symbol	Colour of Button	Cat. No.	Approx. Weight (kgs.)
Momentary	E ⊗ 13 14	Green ●	DPB1-□ 10G	0.215
		Red ●	DPB1-□ 10R	
		Yellow ●	DPB1-□ 10Y	
		Black ●	DPB1-□ 10B	
		White ●	DPB1-□ 10W	
	E ⊗ 11 12	Green ●	DPB1-□ 01G	0.215
		Red ●	DPB1-□ 01R	
		Yellow ●	DPB1-□ 01Y	
		Black ●	DPB1-□ 01B	
		White ●	DPB1-□ 01W	
	E ⊗ 13 11 14 12	Green ●	DPB1-□ 11G	0.230
		Red ●	DPB1-□ 11R	
		Yellow ●	DPB1-□ 11Y	
		Black ●	DPB1-□ 11B	
		White ●	DPB1-□ 11W	
	E ⊗ 13 23 14 24	Green ●	DPB1-□ 20G	0.230
		Red ●	DPB1-□ 20R	
		Yellow ●	DPB1-□ 20Y	
		Black ●	DPB1-□ 20B	
		White ●	DPB1-□ 20W	
	E ⊗ 11 21 12 22	Green ●	DPB1-□ 02G	0.230
		Red ●	DPB1-□ 02R	
		Yellow ●	DPB1-□ 02Y	
		Black ●	DPB1-□ 02B	
		White ●	DPB1-□ 02W	

Control Station and Control Panel: Panel Mounted Operating Devices and Windows, IIC

Flameproof and Dust protection by enclosure

Zone 1 & 2 – 21 & 22

Push Button Shaft, DPBS1 series



Dimension in mm.

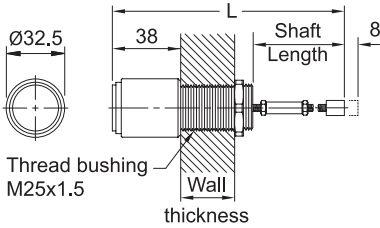

Wall thickness of enclosure (□)		Length (L)
50mm. shaft length	A (15-30mm.)	122.0
	B (31-45mm.)	142.0
100mm. shaft length	A (15-30mm.)	172.0
	B (31-45mm.)	192.0

Mushroom-Head Push Button, DMPB1 series



Dimension in mm.

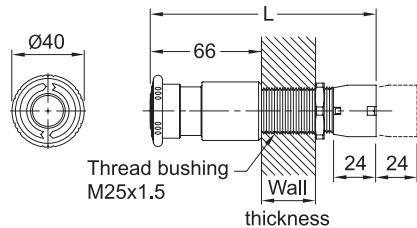

Wall thickness of enclosure (□)		Length (L)
Push-pull	A (15-30mm.)	125.0
	B (31-45mm.)	145.0
Push-Lock, Turn to release	A (15-30mm.)	122.5
	B (31-45mm.)	142.5

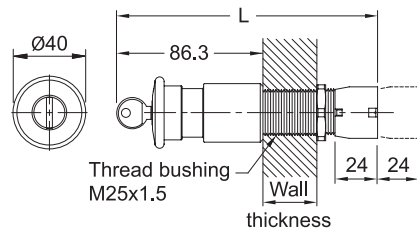

Special Purpose Push Button Shaft, ASPB1 series

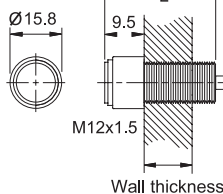
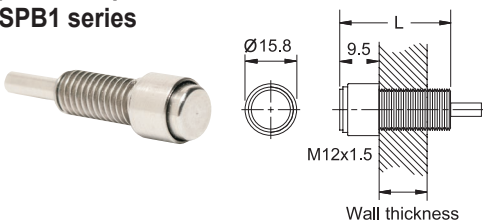

Catalogue Number Logic

DPBS1 - □ ■ ■ ■

Series	Wall thickness of enclosure	Shaft length	Colour of button	
A	15-30 mm.	50 50mm.	G	Green
B	31-45 mm.	1X 100mm.	R	Red
			B	Black
			W	White
			Y	Yellow

Ordering Requirements

Type of Function	Shaft Length	Colour of Button	Cat. No.	Approx. Weight (kgs.)
Momentary	50mm.	Green ●	DPBS1-□ 50G	0.215
		Red ●	DPBS1-□ 50R	
		Yellow ●	DPBS1-□ 50Y	
		Black ●	DPBS1-□ 50B	
	White ●	DPBS1-□ 50W		
	100mm.	Green ●	DPBS1-□ 1XG	
Red ●		DPBS1-□ 1XR		
Yellow ●		DPBS1-□ 1XY		
Black ●		DPBS1-□ 1XB		
		White ●	DPBS1-□ 1XW	

Catalogue Number Logic

DMPB1 - □ ■ ■ ■ R

Series	Wall thickness of enclosure	Type of function	Contact	
A	15-30 mm.	1 Push-pull	10	1NO
B	31-45 mm.	2 Push-lock, Turn to release	20	2NO
		3 Push-lock, Key to release	01	1NC
			02	2NC

Ordering Requirements

Type of Function	Contact	Colour of Button	Cat. No.	Approx. Weight (kgs.)
Push-pull	1NO	Red ●	DMPB1-□ 110R	0.254
Push-lock, Turn to release			DMPB1-□ 210R	0.254
Push-lock, Key to release			DMPB1-□ 310R	0.255
Push-pull	1NC	Red ●	DMPB1-□ 101R	0.254
Push-lock, Turn to release			DMPB1-□ 201R	0.254
Push-lock, Key to release			DMPB1-□ 301R	0.255
Push-pull	2NO	Red ●	DMPB1-□ 120R	0.269
Push-lock, Turn to release			DMPB1-□ 220R	0.269
Push-lock, Key to release			DMPB1-□ 320R	0.270
Push-pull	2NC	Red ●	DMPB1-□ 102R	0.269
Push-lock, Turn to release			DMPB1-□ 202R	0.269
Push-lock, Key to release			DMPB1-□ 302R	0.270

Push-Lock, Key to release

Wall thickness of enclosure (□)	Length (L)
Push-Lock, Key to release	A (15-30mm.) 145.5
	B (31-45mm.) 165.5

Ordering Requirements

Type of Function	Wall Thickness	Colour of Button	Cat. No.
Momentary	15-20mm.	Stainless (natural)	ASPB1-A
	21-45mm.		ASPB1-B

Dimension in mm. (L)

Wall thickness of enclosure (□)	
A (15-20mm.)	B (21-45mm.)
36.5	29.5

Catalogue Number Logic

D ■ ■ ■ 1	-	□	■	■ ■	■
Series	Wall thickness of enclosure	Position	Contact	Function	
DSL1 Selector Switch	A 15-30 mm. B 31-45 mm.	2 2-Positions 3 3-Positions	10 1NO 20 2NO 11 1NO-1NC	S Spring return R Spring return from Right	
DSLK1 Key Selector Switch					

Selector Switch, DSL1 series



Dimension in mm.

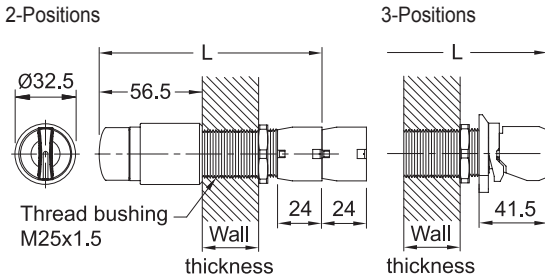

	Wall thickness of enclosure (□)	Length (L)
2-Positions	A (15-30mm.)	115.5
	B (31-45mm.)	165.5
3-Positions	A (15-30mm.)	132.0
	B (31-45mm.)	152.0

Ordering Requirements

Type of Function	Contact	Cat. No.	Approx. Weight (kgs.)
2-Positions			
Stay put (or Maintained)	1NO	DSL1-□ 210	0.230
	2NO	DSL1-□ 220	0.245
	1NO-1NC	DSL1-□ 211	0.245
Spring return	1NO	DSL1-□ 210S	0.230
	2NO	DSL1-□ 220S	0.245
	1NO-1NC	DSL1-□ 211S	0.245
3-Positions			
Stay put (or Maintained)	2NO	DSL1-□ 320	0.250
Spring return from right to centre	2NO	DSL1-□ 320R	0.250

Key Selector Switch, DSLK1 series



Dimension in mm.

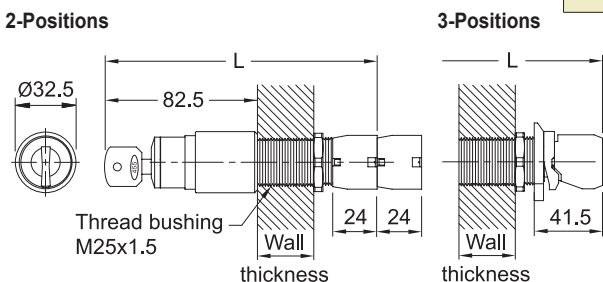

Ordering Requirements

Type of Function	Contact	Cat. No.	Approx. Weight (kgs.)
2-Positions			
Stay put (or Maintained)	1NO	DSLK1-□ 210	0.235
	2NO	DSLK1-□ 220	0.250
	1NO-1NC	DSLK1-□ 211	0.250
3-Positions			
Stay put (or Maintained)	2NO	DSLK1-□ 320	0.255

	Wall thickness of enclosure (□)	Length (L)
2-Positions	A (15-30mm.)	141.5
	B (31-45mm.)	161.5
3-Positions	A (15-30mm.)	158.0
	B (31-45mm.)	178.0

Control Station and Control Panel: Panel Mounted Operating Devices and Windows, IIC

Flameproof and Dust protection by enclosure

Zone 1 & 2 – 21 & 22



Catalogue Number Logic

Series	Wall thickness of enclosure (see dimension table)	Type of function	Ampere
DCM1 Cam operated switch type-1		1 Single pole	16 16A.
ACM1 Cam operated switch type-2		2 Double poles	25 25A.
ACM2 Cam operated switch type-3			32 32A.

Cam Operated Switch Type-1, DCM1 series

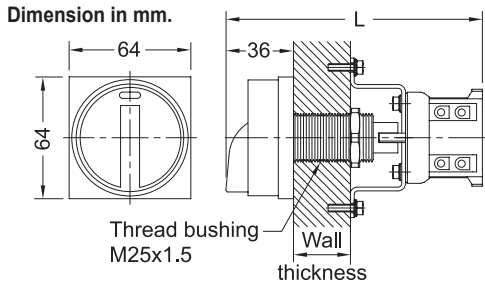
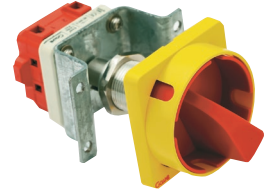

Wall thickness of enclosure (□)	Length (L)
A (15-30mm.)	128.0
B (31-45mm.)	148.0

Ordering Requirements

Ampere	Connection	Cat. No.	Approx. Weight (kgs.)	
2-Steps (Position 45°)				
Single pole	16A.		0.318	
	25A.			DCM1-□ 125
	32A.			DCM1-□ 132
Double poles	16A.		0.350	
	25A.			DCM1-□ 216
	32A.			DCM1-□ 225
			DCM1-□ 232	

Cam Operated Switch Type-2, ACM1 series

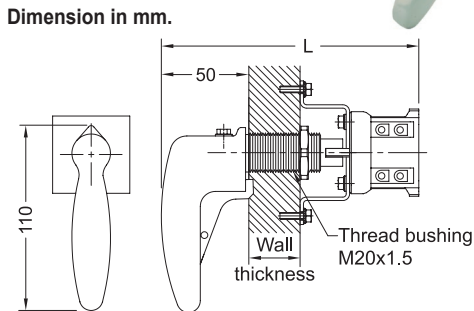

Ordering Requirements

Ampere	Connection	Cat. No.	Approx. Weight (kgs.)	
2-Steps (Position 45°)				
Single pole	16A.		0.24	
	25A.			ACM1-□ 125
	32A.			ACM1-□ 132
Double poles	16A.		0.30	
	25A.			ACM1-□ 216
	32A.			ACM1-□ 225
			ACM1-□ 232	

Wall thickness of enclosure (□)	Length (L)
A (15-20mm.)	138.0
B (21-45mm.)	161.0

Cam Operated Switch Type-3, ACM2 series

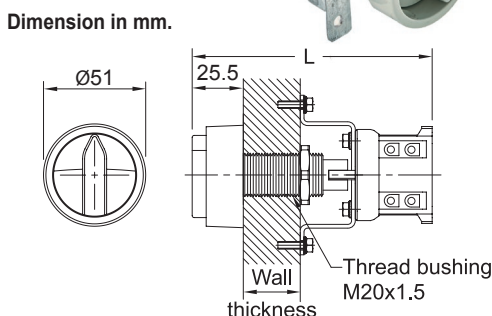
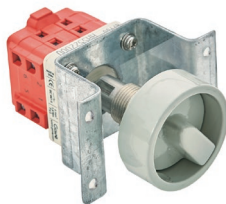

Ordering Requirements

Ampere	Connection	Cat. No.	Approx. Weight (kgs.)	
2-Steps (Position 45°)				
Single pole	16A.		0.24	
	25A.			ACM2-□ 125
	32A.			ACM2-□ 132
Double poles	16A.		0.30	
	25A.			ACM2-□ 216
	32A.			ACM2-□ 225
			ACM2-□ 232	

Wall thickness of enclosure (□)	Length (L)
A (15-20mm.)	113.5
B (21-45mm.)	136.5

Ordering Requirements

Mechanism for Circuit Breaker

Mechanism No.1

for Miniature Circuit Breaker (63AF/ 125AF), ALCB1 series

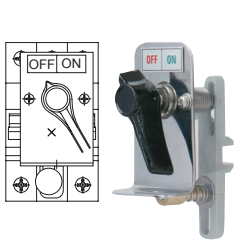

Approx. weight; 0.189 kgs.

Slide Plate (Left)

Wall thickness	Cat. No.
15-20mm.	ALCB1L-A
21-45mm.	ALCB1L-B

Slide Plate (Right)

Wall thickness	Cat. No.
15-20mm.	ALCB1R-A
21-45mm.	ALCB1R-B

Mechanism No.3

for Molded-Case Circuit Breaker (400 to 800AF), ALCB3 series

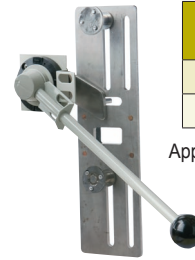
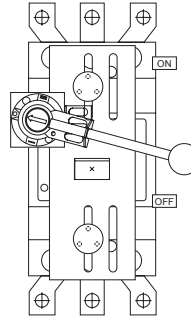

Wall thickness	Cat. No.
15-20mm.	ALCB3-A
21-45mm.	ALCB3-B

Approx. weight; 2.707 kgs.

Remark: The molded-case circuit breaker ALCB series is limited for installation on enclosures with internal free volume $\leq 2000\text{cm}^3$.

Mechanism No.2 for Molded-Case Circuit Breaker (30 to 250AF), ALCB2 series

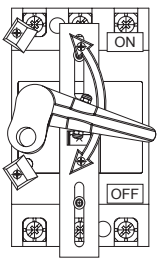

Handle Type-1

Wall thickness	Cat. No.
15-20mm.	ALCB21-A
21-45mm.	ALCB21-B

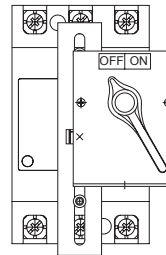

Handle Type-2

Wall thickness	Cat. No.
15-20mm.	ALCB22-A
21-45mm.	ALCB22-B

Approx. weight; 0.425 kgs.

Inspection Window (Round type), LGCR/ LGCR1 series

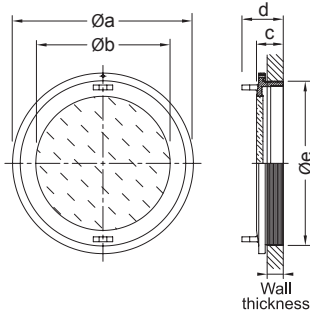

Ordering Requirements

Lens diameter * øb (mm.)	Cat. No.	Dimension in mm.				Wall thickness	Approx. Weight (kgs.)
		øa	c	d	øe		
117	LGCR-113	189			M164	15-45mm.	1.52
179	LGCR-217	251	46	61	M226		2.41
208	LGCR-320	280			M255		2.89

* Suitable for meters with maximum panel size of 96x96mm. or 72x72mm. respectively.

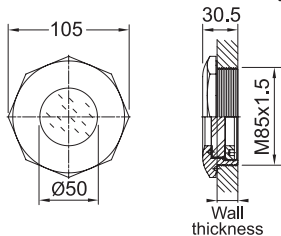

Lens diameter * (mm.)	Cat. No.	Wall thickness	Approx. Weight (kgs.)
50	LGCR1-50-M85	10-45mm.	0.515

* Suitable for meters with maximum panel size of 48x48mm.

Inspection Window (Rectangular type), LGCS series

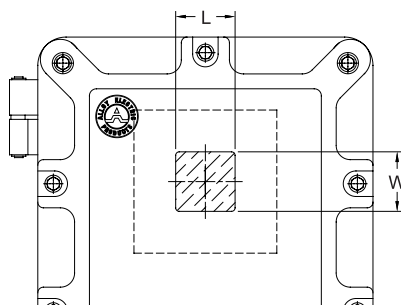

Ordering Requirements

Cat. No.	Dimension in mm.		Wall thickness
	W	L	
LGCS-142	42	42	15-45mm.
LGCS-260	60	60	
LGCS-383	83	83	
LGCS-430	30	145	
LGCS-5120	120	120	
LGCS-6200	200	200	

Control Station and Control Panel: Panel Mounted Operating Devices and Windows, IIC

Flameproof and Dust protection by enclosure

Zone 1 & 2 – 21 & 22



Application

The panel mounted operating devices are designed for used with the flameproof enclosure and dust protection enclosure for controlling or indicating the status of electrical equipment such as motor starter, control equipment operation. They are suitable for Zone 1, 2 and Zone 21, 22 hazardous areas.

Specification

- Thread coupling, Shaft : Stainless steel, SUS 304 (optional SUS 316)
- Thread bushing : Aluminium (optional Stainless steel, SUS 316)
- Lock nut : Nickel-plated brass
- Flush button : Plastic (standard)
- O-ring : Neoprene

Technical Data

Hazardous Area	Gas	Dust
Zones	1 & 2	21 & 22
Equipment Group/Category	Ex II 2G	Ex II 2D
Symbol of Protection	Ex db IIC Gb	Ex tb IIIC Db
Certificate No.	KDB 23 ATEX 0029U	
Conformity to Standards	IECEx KDB 23.0009U	
	EN IEC 60079-0:2018, EN 60079-1:2014, EN 60079-31:2014	
	IEC 60079-0:2017, IEC 60079-1:2014, IEC 60079-31:2013	
Ambient Temperature	-40°C to +65°C	
Index of Protection	IP66	

Electrical Rating

Pilot lights characteristics				
Current consumption	For all colours	24V.dc/ac	20mA. (27 max)	
		120V.ac	18mA. (21 max)	
		230-240V.ac	16mA. (20 max)	
Voltage limit	At nominal voltage	24V.dc	19.2-30V.dc	
		24V.ac	26.1-26.4V.ac	
		120V.ac	100-132V.ac	
Service life	At nominal voltage and at an ambient temp. of 25°C	230-240V.ac	195-264V.ac	
			70,000Hrs.	

Contact Block ratings				
Rated operational current (EN/IEC 60947-5-1)	AC15	240V.	3A.	
		600V.	1.2A.	
Rated thermal current	DC13	250V.	0.27A.	
		600V.	0.1A.	
Rated insulation voltage		10A.		
		600V.		

Cam operated switches				
Rated operational current (EN/IEC 60947-3)	16A.	25A.	32A.	
	20A.	30A.	40A.	
	400V.	400V.	600V.	

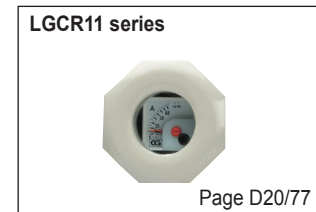
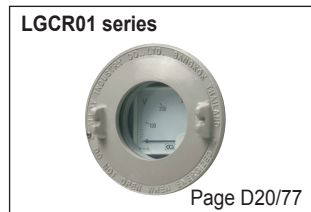
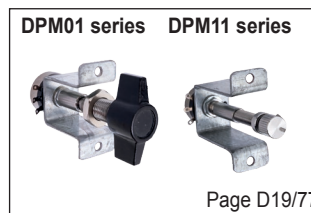
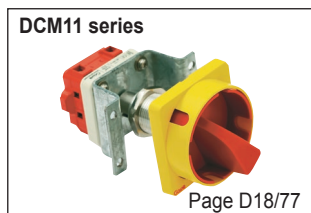
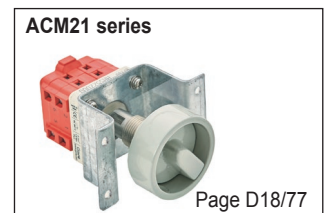
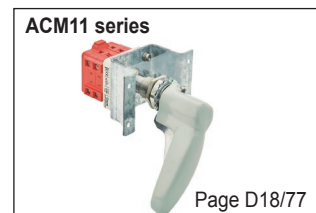
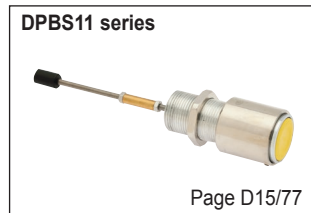



Control Station and Control Panel: Panel Mounted Operating Devices and Windows, IIC

Flameproof and Dust protection by enclosure

Zone 1 & 2 – 21 & 22

Pilot Light, DPL11 series



Dimension in mm.

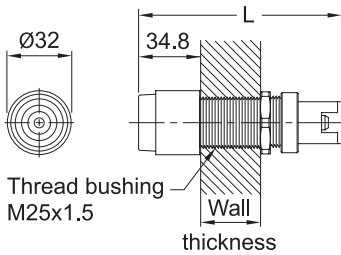

Wall thickness of enclosure (□)	Length (L)
A (15-30mm.)	99.0
B (31-45mm.)	119.0

Pilot Light, DPL01 series



Dimension in mm.

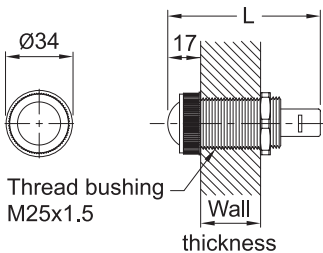

Wall thickness of enclosure (□)	Length (L)
A (15-30mm.)	75.0
B (31-45mm.)	90.0

Catalogue Number Logic

DPL11 - □ ■ ■ ■ ■

Series	Wall thickness of enclosure	Voltage	Colour of lens
A	15-30 mm.	D24 24V.dc/ac	G Green B Blue
B	31-45 mm.	A12 120V.ac	R Red C Clear
		A22 220-230V.ac	Y Yellow

Ordering Requirements

Operating Voltage	Diagram (Integral LED)	Colour of Lens	Cat. No.	Approx. Weight (kgs.)
24V.dc/ ac ~	X1 ⊗ X2	Green ●	DPL11-□ D02G	0.145
		Red ●	DPL11-□ D02R	
		Yellow ●	DPL11-□ D02Y	
		Blue ●	DPL11-□ D02B	
		Clear ●	DPL11-□ D02C	
120V.ac ~	X1 ⊗ X2	Green ●	DPL11-□ A12G	0.145
		Red ●	DPL11-□ A12R	
		Yellow ●	DPL11-□ A12Y	
		Blue ●	DPL11-□ A12B	
		Clear ●	DPL11-□ A12C	
220/230V.ac 50/60Hz. ~	X1 ⊗ X2	Green ●	DPL11-□ A22G	0.145
		Red ●	DPL11-□ A22R	
		Yellow ●	DPL11-□ A22Y	
		Blue ●	DPL11-□ A22B	
		Clear ●	DPL11-□ A22C	

Catalogue Number Logic

DPL01 - □ ■ ■ ■ ■

Series	Wall thickness of enclosure	Voltage	Colour of lens
A	15-30 mm.	D06 6V.dc/ac	G Green B Blue
B	31-45 mm.	D12 12V.dc/ac	R Red C Clear
		D24 24V.dc/ac	Y Yellow
		D11 110V.dc/ac	
		A22 220/230V.ac	
		A38 380V.ac	

Ordering Requirements

Operating Voltage	Diagram (Integral LED)	Colour of Lens	Cat. No.	Approx. Weight (kgs.)
6V.dc/ ac ~	X1 ⊗ X2	Green ●	DPL01-□ D06G	0.125
		Red ●	DPL01-□ D06R	
		Yellow ●	DPL01-□ D06Y	
		Blue ●	DPL01-□ D06B	
		Clear ●	DPL01-□ D06C	
12V.dc/ ac ~	X1 ⊗ X2	Green ●	DPL01-□ D12G	0.125
		Red ●	DPL01-□ D12R	
		Yellow ●	DPL01-□ D12Y	
		Blue ●	DPL01-□ D12B	
		Clear ●	DPL01-□ D12C	
24V.dc/ ac ~	X1 ⊗ X2	Green ●	DPL01-□ D24G	0.125
		Red ●	DPL01-□ D24R	
		Yellow ●	DPL01-□ D24Y	
		Blue ●	DPL01-□ D24B	
		Clear ●	DPL01-□ D24C	
110V.dc/ ac ~	X1 ⊗ X2	Green ●	DPL01-□ D11G	0.125
		Red ●	DPL01-□ D11R	
		Yellow ●	DPL01-□ D11Y	
		Blue ●	DPL01-□ D11B	
		Clear ●	DPL01-□ D11C	
220/230V.ac 50/60Hz. ~	X1 ⊗ X2	Green ●	DPL01-□ A22G	0.125
		Red ●	DPL01-□ A22R	
		Yellow ●	DPL01-□ A22Y	
		Blue ●	DPL01-□ A22B	
		Clear ●	DPL01-□ A22C	
380V.ac 50/60Hz. ~	X1 ⊗ X2	Green ●	DPL01-□ A38G	0.125
		Red ●	DPL01-□ A38R	
		Yellow ●	DPL01-□ A38Y	
		Blue ●	DPL01-□ A38B	
		Clear ●	DPL01-□ A38C	

Control Station and Control Panel: Panel Mounted Operating Devices and Windows, IIC

Flameproof and Dust protection by enclosure

Zone 1 & 2 – 21 & 22



Push Button, DPB11 series



Dimension in mm.

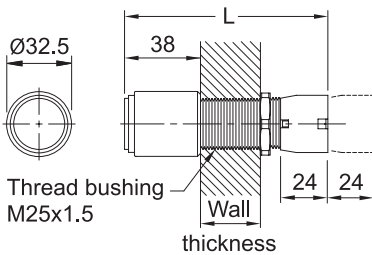

Plastic Flush Button (standard)

Wall thickness of enclosure (□)	Length (L)
A (15-30mm.)	96.0
B (31-45mm.)	116.0

Aluminium Flush Button (option)

Wall thickness of enclosure (□)	Length (L)
A (15-30mm.)	94.0
B (31-45mm.)	114.0

Push Button Shaft, DPBS11 series



Dimension in mm.

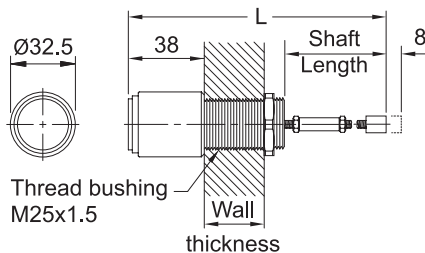

Wall thickness of enclosure (□)	Length (L)	
50mm. shaft length	A (15-30mm.)	122.0
	B (31-45mm.)	142.0
100mm. shaft length	A (15-30mm.)	172.0
	B (31-45mm.)	192.0

Catalogue Number Logic

Series	Wall thickness of enclosure	Contact	Colour of button	Button material
DPB2 - □	A 15-30 mm. B 31-45 mm.	10 1NO 01 1NC 11 1NO-1NC 20 2NO 02 2NC	G Green R Red Y Yellow B Black W White	none Plastic (standard) A Aluminium (Option)

Ordering Requirements

Type of Function	Contact Symbol	Colour of Button	Cat. No.	Approx. Weight (kgs.)
Momentary	1NO	Green ●	DPB11-□ 10G ○	0.215
		Red ●	DPB11-□ 10R ○	
		Yellow ●	DPB11-□ 10Y ○	
		Black ●	DPB11-□ 10B ○	
		White ●	DPB11-□ 10W ○	
Momentary	1NC	Green ●	DPB11-□ 01G ○	0.215
		Red ●	DPB11-□ 01R ○	
		Yellow ●	DPB11-□ 01Y ○	
		Black ●	DPB11-□ 01B ○	
		White ●	DPB11-□ 01W ○	
Momentary	1NO-1NC	Green ●	DPB11-□ 11G ○	0.230
		Red ●	DPB11-□ 11R ○	
		Yellow ●	DPB11-□ 11Y ○	
		Black ●	DPB11-□ 11B ○	
		White ●	DPB11-□ 11W ○	
Momentary	2NO	Green ●	DPB11-□ 20G ○	0.230
		Red ●	DPB11-□ 20R ○	
		Yellow ●	DPB11-□ 20Y ○	
		Black ●	DPB11-□ 20B ○	
		White ●	DPB11-□ 20W ○	
Momentary	2NC	Green ●	DPB11-□ 02G ○	0.230
		Red ●	DPB11-□ 02R ○	
		Yellow ●	DPB11-□ 02Y ○	
		Black ●	DPB11-□ 02B ○	
		White ●	DPB11-□ 02W ○	

Catalogue Number Logic

Series	Wall thickness of enclosure	Shaft length	Colour of button	Button material
DPBS11 - □	A 15-30 mm. B 31-45 mm.	50 50mm. 1X 100mm.	G Green R Red Y Yellow B Black W White	none Plastic (standard) A Aluminium (Option)

Ordering Requirements

Type of Function	Shaft Length	Colour of Button	Cat. No.	Approx. Weight (kgs.)
Momentary	50mm.	Green ●	DPBS11-□ 50G ○	0.215
		Red ●	DPBS11-□ 50R ○	
		Yellow ●	DPBS11-□ 50Y ○	
		Black ●	DPBS11-□ 50B ○	
		White ●	DPBS11-□ 50W ○	
Momentary	100mm.	Green ●	DPBS11-□ 1XG ○	0.235
		Red ●	DPBS11-□ 1XR ○	
		Yellow ●	DPBS11-□ 1XY ○	
		Black ●	DPBS11-□ 1XB ○	
		White ●	DPBS11-□ 1XW ○	

Mushroom-Head Push Button, DMPB11 series



Dimension in mm.

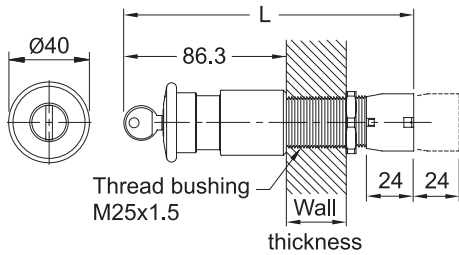

Push-Lock, Key to release

Wall thickness of enclosure (□)	Length (L)
Push-Lock, Key to release A (15-30mm.)	145.5
B (31-45mm.)	165.5

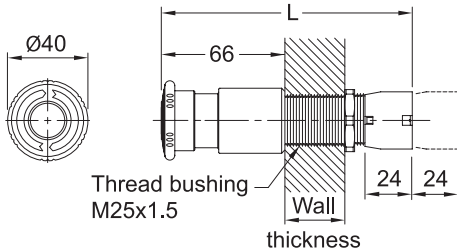

Wall thickness of enclosure (□)	Length (L)
Push-pull A (15-30mm.)	125.0
B (31-45mm.)	145.0
Push-Lock, Turn to release A (15-30mm.)	122.5
B (31-45mm.)	142.5

Special Purpose Push Button Shaft, ASPB11 series

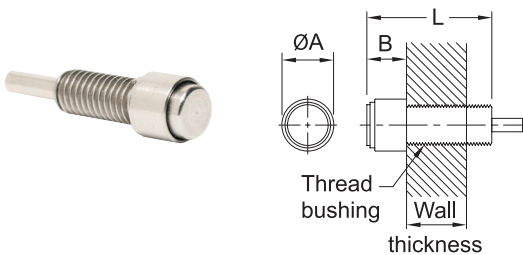

Catalogue Number Logic

DMPB11 - □ ■ ■ ■ R

Series	Wall thickness of enclosure	Type of function	Contact
A	15-30 mm.	1 Push-pull	10 1NO 20 2NO
B	31-45 mm.	2 Push-lock, Turn to release	01 1NC 02 2NC
		3 Push-lock, Key to release	

Ordering Requirements

Type of Function	Contact	Colour of Button	Cat. No.	Approx. Weight (kgs.)
Push-pull	1NO	Red	DMPB11-□ 110R	0.254
Push-lock, Turn to release		●	DMPB11-□ 210R	0.254
Push-lock, Key to release			DMPB11-□ 310R	0.255
Push-pull	1NC	Red	DMPB11-□ 101R	0.254
Push-lock, Turn to release		●	DMPB11-□ 201R	0.254
Push-lock, Key to release			DMPB11-□ 301R	0.255
Push-pull	2NO	Red	DMPB11-□ 120R	0.269
Push-lock, Turn to release		●	DMPB11-□ 220R	0.269
Push-lock, Key to release			DMPB11-□ 320R	0.270
Push-pull	2NC	Red	DMPB11-□ 102R	0.269
Push-lock, Turn to release		●	DMPB11-□ 202R	0.269
Push-lock, Key to release			DMPB11-□ 302R	0.270

Pad Lock/ Padlock Cover (Optional)

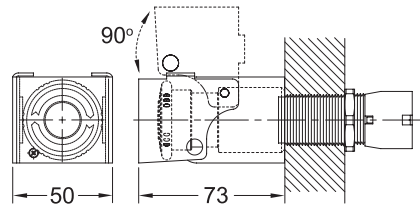

Material: Stainless steel, SUS304

Ordering Requirements

Type of Function	Thread Bushing	Wall Thickness	Colour of Button	Cat. No.
Momentary	M8x1.25	15-20mm.	Stainless (natural)	ASPB11-A1-M8
		21-45mm.		ASPB11-B1-M8
	M12x1.5	15-20mm.		ASPB11-A2-M12
		21-45mm.		ASPB11-B2-M12

Cat. No.	Dimension in mm.		
	ØA	B	Length (L)
ASPB11-A1-M8	11.0	8.5	36.5
ASPB11-B1-M8			59.5
ASPB11-A2-M12	15.8	9.5	36.5
ASPB11-B2-M12			59.5

Control Station and Control Panel: Panel Mounted Operating Devices and Windows, IIC

Flameproof and Dust protection by enclosure

Zone 1 & 2 – 21 & 22



Catalogue Number Logic

D ■ ■ ■ 11		□	■	■ ■	■
Series		Wall thickness of enclosure	Position	Contact	Function
DSL11	Selector Switch	A 15-30 mm.	2 2-Positions	10 1NO 20 2NO	S Spring return
DSLK11	Key Selector Switch	B 31-45 mm.	3 3-Positions	11 1NO-1NC	R Spring return from Right

Selector Switch, DSL11 series



Dimension in mm.

2-Positions

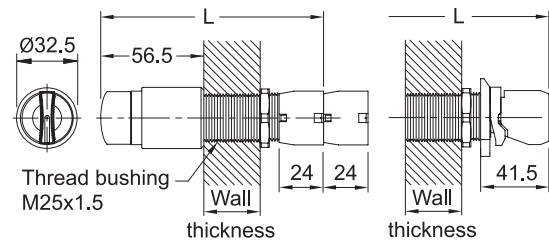

3-Positions

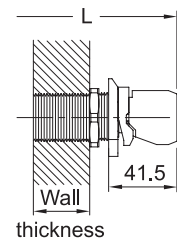

Wall thickness of enclosure (□)		Length (L)
2-Positions	A (15-30mm.)	115.5
	B (31-45mm.)	165.5
3-Positions	A (15-30mm.)	132.0
	B (31-45mm.)	152.0

Ordering Requirements

Type of Function	Contact	Cat. No.	Approx. Weight (kgs.)
2-Positions			
Stay put (or Maintained)	1NO	DSL11-□ 210	0.230
	2NO	DSL11-□ 220	0.245
	1NO-1NC	DSL11-□ 211	0.245
Spring return	1NO	DSL11-□ 210S	0.230
	2NO	DSL11-□ 220S	0.245
	1NO-1NC	DSL11-□ 211S	0.245
3-Positions			
Stay put (or Maintained)	2NO	DSL11-□ 320	0.250
Spring return from right to centre	2NO	DSL11-□ 320R	0.250

Key Selector Switch, DSLK11 series



Dimension in mm.

2-Positions

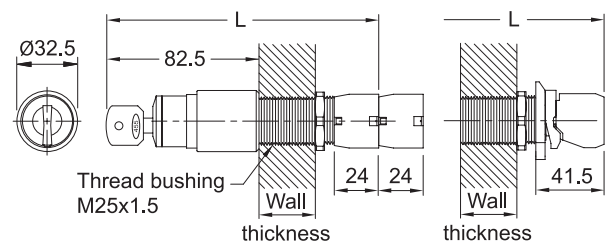

3-Positions

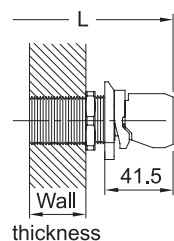

Ordering Requirements

Type of Function	Contact	Cat. No.	Approx. Weight (kgs.)
2-Positions			
Stay put (or Maintained)	1NO	DSLK11-□ 210	0.235
	2NO	DSLK11-□ 220	0.250
	1NO-1NC	DSLK11-□ 211	0.250
3-Positions			
Stay put (or Maintained)	2NO	DSLK11-□ 320	0.255

Wall thickness of enclosure (□)		Length (L)
2-Positions	A (15-30mm.)	141.5
	B (31-45mm.)	161.5
3-Positions	A (15-30mm.)	158.0
	B (31-45mm.)	178.0



Catalogue Number Logic

■ ■ ■ 1	□	■	■ ■
Series	Wall thickness of enclosure (see dimension table)	Type of function	Ampere
DCM11 Cam operated switch type-1		1 Single pole	16 16A.
ACM11 Cam operated switch type-2		2 Double poles	25 25A.
ACM21 Cam operated switch type-3			32 32A.

Dimension in mm.

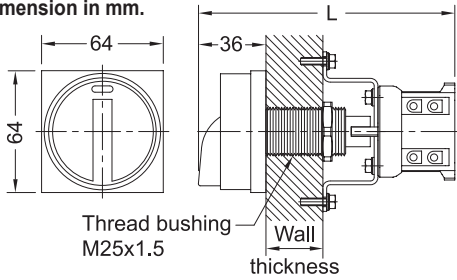

Wall thickness of enclosure (□)	Length (L)
A (15-30mm.)	128.0
B (31-45mm.)	148.0

Ordering Requirements

Ampere	Connection	Cat. No.	Approx. Weight (kgs.)									
2-Steps (Position 45°)												
Single pole	16A.	<table border="1"> <tr><td>1</td><td>2</td><td>X</td></tr> <tr><td>0</td><td>1</td><td></td></tr> </table>	1	2	X	0	1		0.318			
	1		2	X								
	0		1									
25A.	DCM11-□ 125											
32A.	DCM11-□ 132											
Double poles	16A.	<table border="1"> <tr><td>3</td><td>4</td><td>X</td></tr> <tr><td>1</td><td>2</td><td>X</td></tr> <tr><td>0</td><td>1</td><td></td></tr> </table>	3	4	X	1	2	X	0	1		0.350
	3		4	X								
	1		2	X								
0	1											
25A.	DCM11-□ 225											
32A.	DCM11-□ 232											

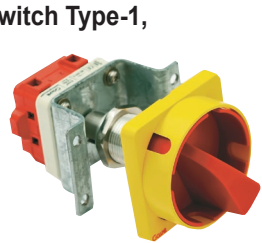

Cam Operated Switch Type-2, ACM11 series



Dimension in mm.

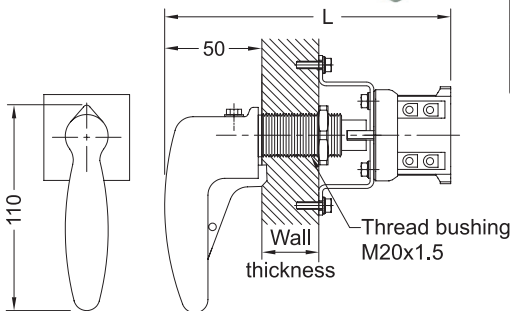

Ordering Requirements

Ampere	Connection	Cat. No.	Approx. Weight (kgs.)									
2-Steps (Position 45°)												
Single pole	16A.	<table border="1"> <tr><td>1</td><td>2</td><td>X</td></tr> <tr><td>0</td><td>1</td><td></td></tr> </table>	1	2	X	0	1		0.24			
	1		2	X								
	0		1									
25A.	ACM11-□ 125											
32A.	ACM11-□ 132											
Double poles	16A.	<table border="1"> <tr><td>3</td><td>4</td><td>X</td></tr> <tr><td>1</td><td>2</td><td>X</td></tr> <tr><td>0</td><td>1</td><td></td></tr> </table>	3	4	X	1	2	X	0	1		0.30
	3		4	X								
	1		2	X								
0	1											
25A.	ACM11-□ 225											
32A.	ACM11-□ 232											

Wall thickness of enclosure (□)	Length (L)
A (15-20mm.)	138.0
B (21-45mm.)	161.0

Cam Operated Switch Type-3, ACM21 series

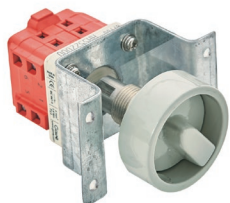

Dimension in mm.

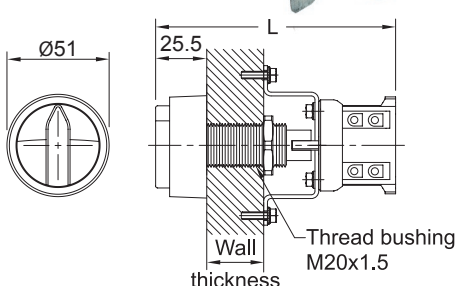

Ordering Requirements

Ampere	Connection	Cat. No.	Approx. Weight (kgs.)									
2-Steps (Position 45°)												
Single pole	16A.	<table border="1"> <tr><td>1</td><td>2</td><td>X</td></tr> <tr><td>0</td><td>1</td><td></td></tr> </table>	1	2	X	0	1		0.24			
	1		2	X								
	0		1									
25A.	ACM21-□ 125											
32A.	ACM21-□ 132											
Double poles	16A.	<table border="1"> <tr><td>3</td><td>4</td><td>X</td></tr> <tr><td>1</td><td>2</td><td>X</td></tr> <tr><td>0</td><td>1</td><td></td></tr> </table>	3	4	X	1	2	X	0	1		0.30
	3		4	X								
	1		2	X								
0	1											
25A.	ACM21-□ 225											
32A.	ACM21-□ 232											

Wall thickness of enclosure (□)	Length (L)
A (15-20mm.)	113.5
B (21-45mm.)	136.5

Control Station and Control Panel: Panel Mounted Operating Devices and Windows, IIC

Flameproof and Dust protection by enclosure

Zone 1 & 2 – 21 & 22

Mechanism for Potentiometer (Variable resistor)

Type 1, DPM01 series

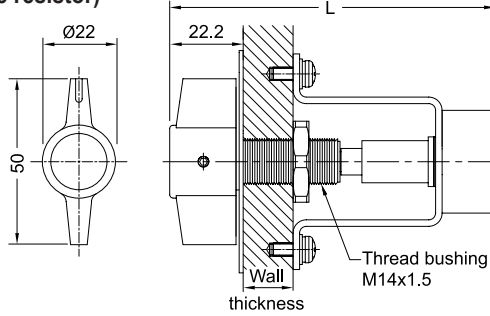

Wall thickness of enclosure	Cat. No.	Length (L)
A (15-20mm.)	DPM01-A	98.2
B (21-45mm.)	DPM01-B	123.2

Type 2, DPM11 series

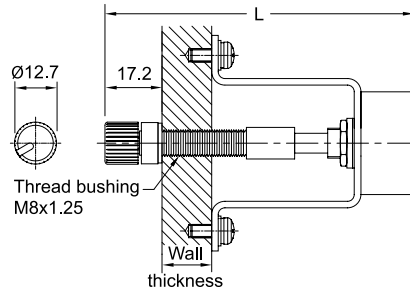
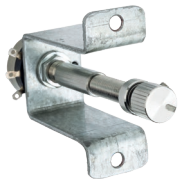

Wall thickness of enclosure	Cat. No.	Length (L)
A (15-20mm.)	DPM11-A	93.2
B (21-45mm.)	DPM11-B	118.2

Mechanism for Circuit Breaker

Mechanism No.1, ALCB11 series

Type-1 for Miniature Circuit Breaker (63AF/ 125AF)

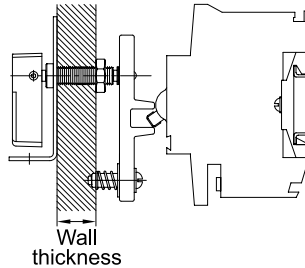
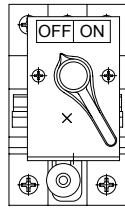

Slide Plate (Left)

Wall thickness of enclosure	Cat. No.
A (15-20mm.)	ALCB11L-A
B (21-45mm.)	ALCB11L-B

Slide Plate (Right)

Wall thickness of enclosure	Cat. No.
A (15-20mm.)	ALCB11R-A
B (21-45mm.)	ALCB11R-B

Approx. weight; 0.189 kgs.

Type-2 for Safety Breaker

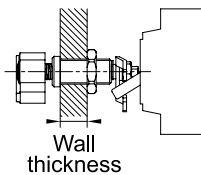
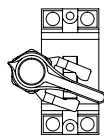

Wall thickness of enclosure	Cat. No.
A (15-20mm.)	ALCB11S-A
B (21-45mm.)	ALCB11S-B

Mechanism No.2 for Molded-Case Circuit Breaker (30 to 250AF), ALCB21 series

Handle Type-1

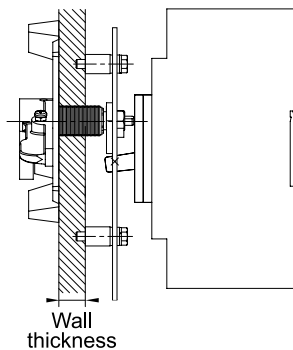
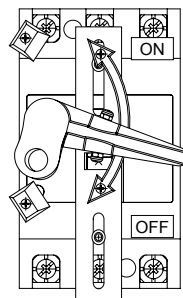

Wall thickness of enclosure	Cat. No.
A (15-20mm.)	ALCB211-A
B (21-45mm.)	ALCB211-B

Handle Type-2

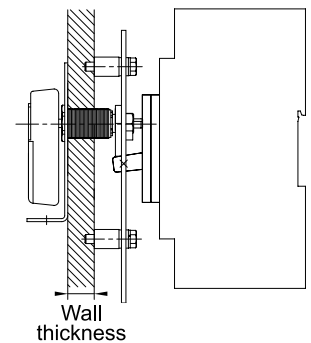
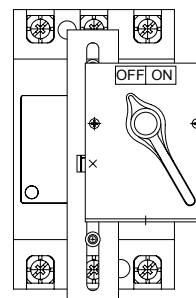

Wall thickness of enclosure	Cat. No.
A (15-20mm.)	ALCB212-A
B (21-45mm.)	ALCB212-B

Mechanism No.3 for Molded-Case Circuit Breaker(400 to 800AF), ALCB31 series

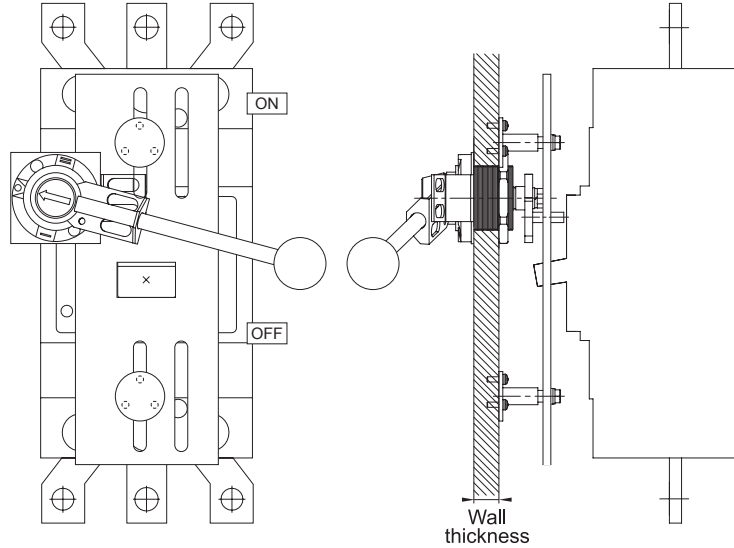

Wall thickness of enclosure	Cat. No.
A (15-20mm.)	ALCB31-A
B (21-45mm.)	ALCB31-B

Inspection Window (Round type), LGCR01/ LGCR11 series

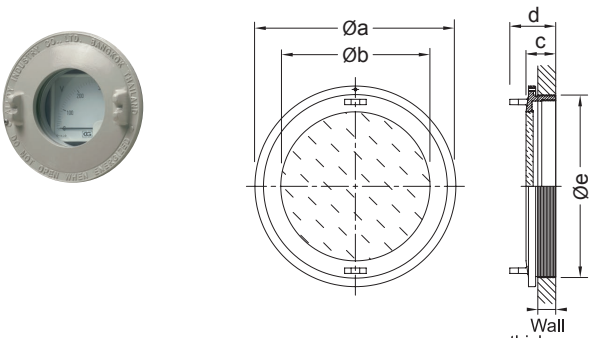

Ordering Requirements

Lens diameter * øb (mm.)	Cat. No.	Dimension in mm.				Wall thickness	Approx. Weight (kgs.)	
		øa	c	d	øe			
117	LGCR01-113	189	46	61	M164	15-45mm.	1.52	
179	LGCR01-217	251					M226	2.41
208	LGCR01-320	280					M255	2.89

* Suitable for meters with maximum panel size of 96x96mm. or 72x72mm. respectively.

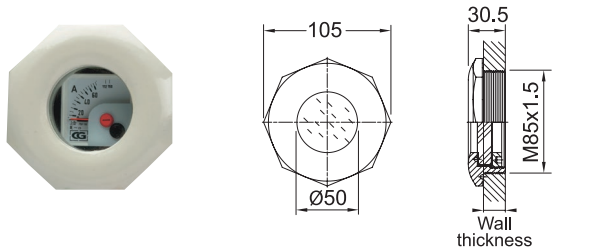

Lens diameter * (mm.)	Cat. No.	Wall thickness	Approx. Weight (kgs.)
50	LGCR11-50-M85	10-45mm.	0.515

* Suitable for meters with maximum panel size of 48x48mm.

Inspection Window (Rectangular type), LGCS01 series

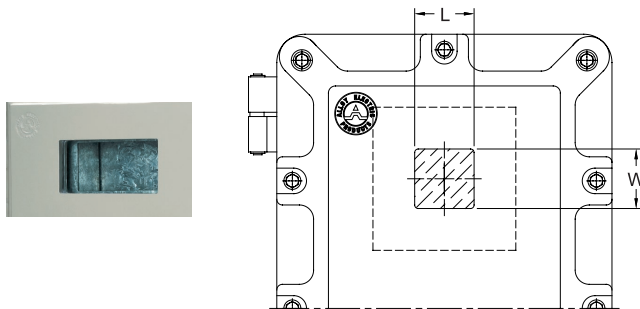

Ordering Requirements

Cat. No.	Dimension in mm.		Wall thickness
	W	L	
LGCS01- 125	20	50	15-45mm.
LGCS01- 255	50	50	
LGCS01- 377	70	70	
LGCS01- 499	95	95	
LGCS01- 5310	30	100	
LGCS01- 6314	30	145	
LGCS01- 7510	50	100	
LGCS01- 81010	100	100	
LGCS01- 91212	120	120	
LGCS01- 101515	150	150	
LGCS01- 112020	200	200	
LGCS01- 122441	240	410	