



Conduit Fitting: Reducer and Adaptor (Enlarger), DRH and DAT Series

Flameproof and Dust protection by enclosure

Zone 1 & 2 – 21 & 22

Application

Reducer and Adaptor are provided a means of attachment between dissimilar thread types or thread sizes.

Specification

- Body : Brass (optional nickel-plated brass)
- Entry thread seal : Nylon (PA6) (for metric threads only)

Ordering

add option (-□) to Cat. No. (Brass only)
e.g. DAT-M13-NI (Nickel-plated brass)

Technical Data

Hazardous Area	Gas	Dust
Zones	1 & 2	21 & 22
Equipment Group/Category	⊕ II 2G	⊕ II 2D
Symbol of Protection	Ex d IIC Gb	Ex tb IIIC Db
Certificate No.	LCIE 13 ATEX 3046U IECEx LCIE 13.0028U	
T Rating	Temperature class of enclosure to which will be connected.	
Conformity to Standards	EN 60079-0:2012, EN 60079-1:2007, EN 60079-31:2009 IEC 60079-0:2011, IEC 60079-1:2007-04, IEC 60079-31:2008	
Ambient Temperature	-20°C to +75°C	
Index of Protection	IP66	



Selection Chart for Reducer and Adaptor (Enlarger)

		Female Threads																				
		M16 x 1.5	M20 x 1.5	M25 x 1.5	M32 x 1.5	M40 x 1.5	M50 x 1.5	M63 x 1.5	M75 x 1.5	M90 x 2.0	M100 x 2.0	NPT 1/2"	NPT 3/4"	NPT 1"	NPT 1-1/4"	NPT 1-1/2"	NPT 2"	NPT 2-1/2"	NPT 3"	NPT 3-1/2"	NPT 4"	
Male Threads	M16 x 1.5		A	A	A							A	A	A								
	M20 x 1.5	R		A	A	A						A	A	A								
	M25 x 1.5	R	R		A	A	A					R	A	A	A							
	M32 x 1.5	R	R	R		A	A	A				R	R	A	A	A						
	M40 x 1.5		R	R	R		A	A	A			R	R	R	A	A	A					
	M50 x 1.5			R	R	R		A	A	A		R	R	R	A	A	A					
	M63 x 1.5				R	R	R		A	A	A	R	R	R	A	A	A					
	M75 x 1.5					R	R	R		A	A	R	R	R	A	A	A					
	M90 x 2.0						R	R	R		A	R	R	R	A	A	A					
	M100 x 2.0							R	R	R		R	R	R	A	A	A					
												Male Threads										
		NPT 1/2"	NPT 3/4"	NPT 1"	NPT 1-1/4"	NPT 1-1/2"	NPT 2"	NPT 2-1/2"	NPT 3"	NPT 3-1/2"	NPT 4"											
		R	A	A								A	A	A								
		R	R	A	A	A						R		A	A	A						
		R	R	R	A	A	A					R	R		A	A	A					
			R	R	R	A	A	A				R	R	R		A	A	A				
				R	R	R	A	A	A			R	R	R		A	A	A				
					R	R	R	A	A	A		R	R	R		A	A	A				
						R	R	R	A	A		R	R	R		A	A	A				
							R	R	R	A		R	R	R		A	A	A				
								R	R	R	A	R	R	R		A	A	A				
									R	R	R	R	R	R		A	A	A				

R Reducer, DRH series

A Adaptor (Enlarger), DAT series



A QUALITY PRODUCT

Conduit Fitting: Adaptor (Enlarger), DAT Series

Flameproof and Dust protection by enclosure

Zone 1 & 2 – 21 & 22

Ordering Requirements and Dimension

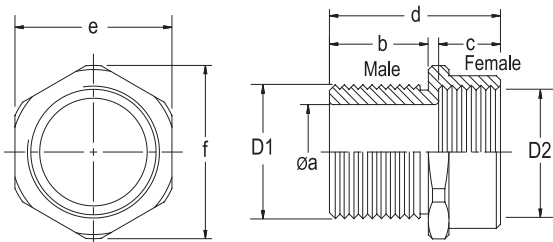

NPT threads

Cat. No.	Entries Thread		Dimension in mm.					
	D1 (Male)	D2 (Female)	a	b	c	d	e	f
DAT-N12		3/4" NPT			15.0	40.85	38.1	42.0
DAT-N13	1/2" NPT	1" NPT	14.0	19.85	17.0	42.85	44.4	49.0
DAT-N14		1-1/4" NPT						
DAT-N23	3/4" NPT	1" NPT	18.0	20.15	17.0	43.15	44.4	49.0
DAT-N24		1-1/4" NPT						
DAT-N25		1-1/2" NPT						
DAT-N34	1" NPT	1-1/4" NPT	24.0	25.0	17.5	48.5	50.8	56.0
DAT-N35		1-1/2" NPT						
DAT-N36		2" NPT	31.0	25.61	18.0	49.61	76.2	84.0
DAT-N45	1-1/4" NPT	1-1/2" NPT						
DAT-N46		2" NPT						
DAT-N47	1-1/2" NPT	2-1/2" NPT	37.0	26.04	24.0	50.04	89.0	99.0
DAT-N56		2" NPT						
DAT-N57		2-1/2" NPT						
DAT-N58		3" NPT	60.0	39.9	26.0	59.87	114.0	126.0
DAT-N67	2" NPT	2-1/2" NPT						
DAT-N68		3" NPT						
DAT-N69		3-1/2" NPT	74.0	41.49	27.5	76.99	114.0	126.0
DAT-N78	2-1/2" NPT	3" NPT						
DAT-N79		3-1/2" NPT						
DAT-N89	3" NPT	4" NPT	28.0	77.49	127.0	140.0		
DAT-N910		3-1/2" NPT						
DAT-N910		4" NPT	86.0	28.0	78.76	127.0	140.0	

NPT/Metric threads

Cat. No.	Entries Thread		Dimension in mm.					
	D1 (Male)	D2 (Female)	a	b	c	d	e	f
DAT-NM11		M20x1.5				38.85	27.0	30.0
DAT-NM12	1/2" NPT	M25x1.5	14.0	19.85	15.0	40.85	44.4	49.0
DAT-NM13		M32x1.5						
DAT-NM22	3/4" NPT	M25x1.5	18.0	20.15	15.0	39.15	38.1	42.0
DAT-NM23		M32x1.5						
DAT-NM24		M40x1.5						
DAT-NM33	1" NPT	M32x1.5	24.0	25.0	15.0	46.0	50.8	56.0
DAT-NM34		M40x1.5						
DAT-NM35		M50x1.5	31.0	25.61	15.0	46.61	63.5	70.0
DAT-NM44	1-1/4" NPT	M40x1.5						
DAT-NM45		M50x1.5						
DAT-NM46		M63x1.5	37.0	26.04	15.0	47.04	76.2	84.0
DAT-NM55	1-1/2" NPT	M50x1.5						
DAT-NM56		M63x1.5						
DAT-NM57		M75x1.5	49.0	26.87	15.0	47.87	89.0	99.0
DAT-NM66	2" NPT	M63x1.5						
DAT-NM67		M75x1.5						
DAT-NM68		M90x2.0	60.0	39.9	20.0	67.9	101.0	112.0
DAT-NM77	2-1/2" NPT	M75x1.5						
DAT-NM78		M90x2.0						
DAT-NM79		M100x2.0	74.0	41.49	20.0	69.49	101.0	112.0
DAT-NM88	3" NPT	M90x2.0						
DAT-NM89		3-1/2" NPT						
DAT-NM99		M100x2.0	86.0	42.76	70.76	120.0	134.0	

Metric threads

Cat. No.	Entries Thread		Dimension in mm.					
	D1 (Male)	D2 (Female)	a	b	c	d	e	f
DAT-M01		M20x1.5						
DAT-M02	M16x1.5	M25x1.5	10.0	15.0	15.0	34.0	31.0	34.0
DAT-M03		M32x1.5						
DAT-M12	M20x1.5	M25x1.5	14.0	15.0	15.0	36.0	44.4	49.0
DAT-M13		M32x1.5						
DAT-M14		M40x1.5						
DAT-M23	M25x1.5	M32x1.5	17.0	15.0	15.0	36.0	50.8	56.0
DAT-M24		M40x1.5						
DAT-M25		M50x1.5	24.0	15.0	15.0	36.0	63.5	70.0
DAT-M34	M32x1.5	M40x1.5						
DAT-M35		M50x1.5						
DAT-M36		M63x1.5	32.0	15.0	15.0	36.0	76.2	84.0
DAT-M45	M40x1.5	M50x1.5						
DAT-M46		M63x1.5						
DAT-M47		M75x1.5	42.0	15.0	15.0	36.0	89.0	99.0
DAT-M56	M50x1.5	M63x1.5						
DAT-M57		M75x1.5						
DAT-M58		M90x2.0	55.0	15.0	15.0	36.0	101.0	112.0
DAT-M67	M63x1.5	M75x1.5						
DAT-M68		M90x2.0						
DAT-M69		M100x2.0	67.0	15.0	20.0	43.0	120.0	134.0
DAT-M78	M75x1.5	M90x2.0						
DAT-M79		M90x2.0						
DAT-M89		M100x2.0	78.0	20.0	48.0	120.0	134.0	

Metric/NPT threads

Cat. No.	Entries Thread		Dimension in mm.					
	D1 (Male)	D2 (Female)	a	b	c	d	e	f
DAT-MN01		1/2" NPT						
DAT-MN02	M16x1.5	3/4" NPT	10.0	15.0	15.0	34.0	31.0	34.0
DAT-MN03		1" NPT						
DAT-MN11	M20x1.5	1/2" NPT	14.0	15.0	15.0	34.0	31.0	34.0
DAT-MN12		3/4" NPT						
DAT-MN13		1" NPT						
DAT-MN22	M25x1.5	3/4" NPT	17.0	15.0	17.0	38.0	44.5	49.0
DAT-MN23		1" NPT						
DAT-MN24		1-1/4" NPT	24.0	15.0	17.5	38.5	50.8	56.0
DAT-MN33	M32x1.5	1" NPT						
DAT-MN34		1-1/4" NPT						
DAT-MN35		1-1/2" NPT	32.0	15.0	18.0	39.0	76.2	84.0
DAT-MN44	M40x1.5	1-1/4" NPT						
DAT-MN45		1-1/2" NPT						
DAT-MN46		2" NPT	42.0	15.0	18.0	39.0	76.2	84.0
DAT-MN55	M50x1.5	1-1/2" NPT						
DAT-MN56		2" NPT						
DAT-MN57		2-1/2" NPT	55.0	15.0	24.0	45.0	89.0	99.0
DAT-MN66	M63x1.5	2" NPT						
DAT-MN67		2-1/2" NPT						
DAT-MN68		3" NPT	67.0	15.0	26.0	47.0	114.0	126.0
DAT-MN77	M75x1.5	2-1/2" NPT						
DAT-MN78		3" NPT						
DAT-MN79		3-1/2" NPT	78.0	20.0	27.5	53.5	114.0	126.0
DAT-MN88	M90x2.0	3" NPT						
DAT-MN89		3-1/2" NPT						
DAT-MN810		4" NPT	88.0	20.0	28.0	54.0	127.0	140.0
DAT-MN99	M100x2.0	3-1/2" NPT						
DAT-MN910		4" NPT						