



# Cable Fitting: Cable Gland for Non-Armoured Cable, DNAF Series (Female threads ended)

Flameproof/ Increased Safety and Dust protection by enclosure

Zone 1 & 2 – 21 & 22

## Application

The DNAF cable glands are suitable for used in zone 1, 2 and zone 21, 22 hazardous areas to enable direct insertion of normal non-armoured cable into Ex d equipment or enclosure. The gland nut is provided with female threads ended.

## Specification

Body, gland nut : Brass  
(optional nickel-plated brass)  
Thread seal : Nylon (PA6)  
(for metric threads only)

## Catalogue Number Logic

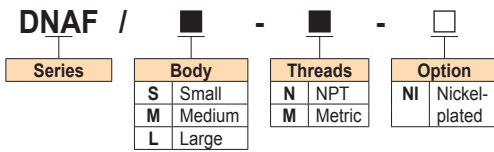

## Ordering Requirements

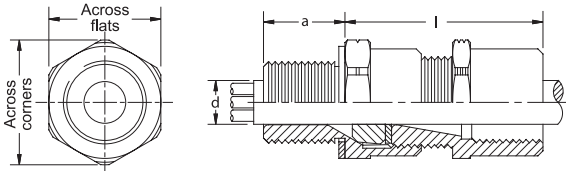

## Technical Data

Hazardous Area	Gas	Dust
Zones	1 & 2	21 & 22
Equipment Group/Category	II 2G	II 2D
Symbol of Protection	Ex db eb IIC Gb	Ex tb IIIC Db
Certificate No.	TÜV CY 18 ATEX 0206101X	
T Rating	Temperature class of enclosure to which will be connected.	
Conformity to Standards	EN 60079-0:2012/A11:2013, EN 60079-1:2014, EN 60079-7:2015, EN 60079-31:2014	
Ambient Temperature	-20°C to +75°C	
Index of Protection	IP66	

Note: Cables for fixed installations shall have flame propagation characteristics which enable them to withstand the tests according to IEC 60332-1-2 or IEC 60332-3-22.



Brass



Nickel-plated brass

Cat. No.	Entries Threads (Male)		Cable Dia. Outer 'd'	Threads Ended (Female)	Dimension in mm.				Approx. Weight (kgs.)
	Metric	NPT			l	a	Across Corners	Across Flats	
DNAF /S -M0N1	-	M16x1.5	-	1/2"	38.5	15.0	26.5	24.0	0.08
DNAF /S -M1N1	-	M20x1.5	-	1/2"	41.5	19.8	26.5	24.0	0.10
DNAF /S -N1	-	-	1/2"	1/2"	41.5	19.8	26.5	24.0	0.11
DNAF /M -M1N1	-	M20x1.5	-	1/2"	38.5	15.0	26.5	24.0	0.10
DNAF /M -N1	-	-	1/2"	1/2"	41.5	19.8	26.5	24.0	0.10
DNAF /L -M1N1	-	M20x1.5	-	1/2"	39.5	15.0	35.0	31.75	0.11
DNAF /S -M2N2	-	M25x1.5	-	3/4"	42.5	19.8	35.0	31.75	0.16
DNAF /L -N1	-	-	1/2"	1/2"	42.5	19.8	35.0	31.75	0.12
DNAF /S -N2	-	-	3/4"	3/4"	42.5	20.1	35.0	31.75	0.17
DNAF /M -M2N2	-	M25x1.5	-	3/4"	46.5	15.0	42.0	38.1	0.17
DNAF /S -M3N3	-	M32x1.5	-	1"	49.5	20.1	42.0	38.1	0.23
DNAF /M -N2	-	-	3/4"	3/4"	54.5	25.0	42.0	38.1	0.25
DNAF /S -N3	-	-	1"	1"	54.5	25.0	42.0	38.1	0.28
DNAF /M -M3N3	-	M32x1.5	-	1"	47.5	15.0	49.0	44.4	0.23
DNAF /S -M4N4	-	M40x1.5	-	1-1/4"	55.5	25.0	49.0	44.4	0.31
DNAF /M -N3	-	-	1"	1"	55.5	25.6	49.0	44.4	0.25
DNAF /S -N4	-	-	1-1/4"	1-1/4"	55.5	25.6	49.0	44.4	0.40
DNAF /M -M4N4	-	M40x1.5	-	1-1/4"	51.0	15.0	56.0	50.8	0.30
DNAF /S -M5N5	-	M50x1.5	-	1-1/2"	59.0	25.6	56.0	50.8	0.45
DNAF /M -N4	-	-	1-1/4"	1-1/4"	59.0	25.6	56.0	50.8	0.37
DNAF /S -N5	-	-	1-1/2"	1-1/2"	59.0	26.0	63.0	57.1	0.49
DNAF /M -M5N5	-	M50x1.5	-	1-1/2"	51.0	15.0	63.0	57.1	0.42
DNAF /M -N5	-	-	1-1/2"	1-1/2"	59.0	26.0	63.0	57.1	0.46
DNAF /L -M5N5	-	M50x1.5	-	1-1/2"	51.0	15.0	70.0	63.5	0.48
DNAF /S -M6N6	-	M63x1.5	-	2"	52.0	15.0	77.0	70.0	0.72
DNAF /L -N5	-	-	1-1/2"	1-1/2"	60.0	26.0	70.0	63.5	0.60
DNAF /S -N6	-	-	2"	2"	60.0	26.9	77.0	70.0	0.80
DNAF /M -M6N6S	-	M63x1.5	-	2"	52.0	15.0	84.0	76.2	0.63
DNAF /S -M7N7S	-	M75x1.5	-	2-1/2"	52.0	15.0	99.0	88.9	1.00
DNAF /M -N6S	-	-	2"	2"	60.0	26.9	84.0	76.2	0.84
DNAF /S -N7S	-	-	2-1/2"	2-1/2"	72.0	39.9	99.0	88.9	1.56
DNAF /M -M6N6L	-	M63x1.5	-	2"	52.0	15.0	84.0	76.2	0.63
DNAF /S -M7N7L	-	M75x1.5	-	2-1/2"	52.0	15.0	99.0	88.9	1.00
DNAF /M -N6L	-	-	2"	2"	60.0	26.9	84.0	76.2	0.84
DNAF /S -N7L	-	-	2-1/2"	2-1/2"	72.0	39.9	99.0	88.9	1.56

Thread seal



Body (Entry thread)



Neoprene inner sealing ring

Sealing washer



Gland nut Female Threads ended