



Cable Fitting: Barrier Cable Gland for Non-Armoured Cable, DNAB Series

Flameproof/ Increased Safety and Dust protection by enclosure

Zone 1 & 2 – 21 & 22

Application

The DNAB cable glands are suitable for used to direct insertion of normal non-armoured cable into Ex db or Ex eb equipment or enclosure.

Specification

- Body, gland nut : Brass
(optional nickel-plated brass)
- Thread seal : Nylon (PA6)
(for metric threads only)
- Seal : Putty compound, -40°C to +120°C
(2-part; resin/hardener)

Catalogue Number Logic

DNAB /

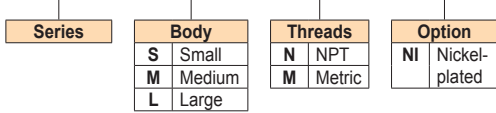

Ordering Requirements

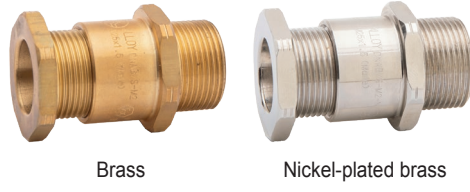
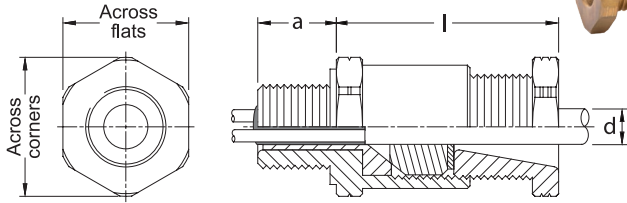

Technical Data

Hazardous Area Zones	Gas	Dust
1 & 2	1 & 2	21 & 22
Equipment Group/Category	II 2G	II 2D
Symbol of Protection	Ex db IIC Gb / Ex eb IIC Gb	Ex tb IIIC Db
Certificate No.	KDB 24 ATEX 0020X IECEx KDB 24.0004X	
T Rating	Temperature class of enclosure to which will be connected.	
Conformity to Standards	EN IEC 60079-0:2018, EN 60079-1:2014, EN IEC 60079-7:2015/A1:2018, EN 60079-31:2014 IEC 60079-0:2017, IEC 60079-1:2014, IEC 60079-7:2015, IEC 60079-31:2013	
Ambient Temperature	-40°C to +75°C	
Index of Protection	IP66	

Note: Cables for fixed installations shall have flame propagation characteristics which enable them to withstand the tests according to IEC 60332-1-2 or IEC 60332-3-22.

Cat. No.	Entries Threads (Male)		Cable Dia. Outer 'd'	Dimension in mm.				Approx. Weight (kgs.)
	Metric	NPT		l	a	Across Corners	Across Flats	
DNAB/S -M0 -□	M16x1.5	-	3.0-8.6	25.0	15.0	26.5	24.0	0.06
DNAB/S -M1 -□	M20x1.5	-		25.0	19.8	26.5	24.0	0.07
DNAB/S -N1 -□	-	1/2"	6.1-11.9	25.0	15.0	26.5	24.0	0.07
DNAB/M -M1 -□	M20x1.5	-		25.0	19.8	26.5	24.0	0.07
DNAB/L -M1 -□	M20x1.5	-	6.5-14.3	26.0	15.0	35.0	31.75	0.09
DNAB/S -M2 -□	M25x1.5	-		26.0	19.8	35.0	31.75	0.11
DNAB/L -N1 -□	-	1/2"	11.1-20.2	26.0	19.8	35.0	31.75	0.08
DNAB/S -N2 -□	-	3/4"		26.0	20.1	35.0	31.75	0.12
DNAB/M -M2 -□	M25x1.5	-	17.0-26.5	33.0	15.0	42.0	38.1	0.14
DNAB/S -M3 -□	M32x1.5	-		33.0	20.1	42.0	38.1	0.18
DNAB/M -N2 -□	-	3/4"	17.0-26.5	33.0	25.0	42.0	38.1	0.14
DNAB/S -N3 -□	-	1"		33.0	25.0	42.0	38.1	0.21
DNAB/M -M3 -□	M32x1.5	-	22.0-32.5	34.0	15.0	49.0	44.4	0.19
DNAB/S -M4 -□	M40x1.5	-		34.0	25.0	49.0	44.4	0.25
DNAB/M -N3 -□	-	1"	22.0-32.5	34.0	25.6	49.0	44.4	0.19
DNAB/S -N4 -□	-	1-1/4"		34.0	25.6	49.0	44.4	0.31
DNAB/M -M4 -□	M40x1.5	-	29.5-38.1	38.0	15.0	56.0	50.8	0.26
DNAB/S -M5 -□	M50x1.5	-		38.0	25.6	56.0	50.8	0.38
DNAB/M -N4 -□	-	1-1/4"	29.5-38.1	38.0	26.0	56.0	50.8	0.30
DNAB/S -N5 -□	-	1-1/2"		38.0	26.0	56.0	50.8	0.41
DNAB/M -M5 -□	M50x1.5	-	35.6-44.0	38.0	15.0	63.0	57.1	0.36
DNAB/S -M6 -□	M63x1.5	-		38.0	26.0	63.0	57.1	0.37
DNAB/M -N5 -□	-	1-1/2"	39.0-44.0	40.0	15.0	70.0	63.5	0.44
DNAB/S -N6 -□	-	2"		40.0	26.0	70.0	63.5	0.65
DNAB/L -M5 -□	M50x1.5	-	39.0-44.0	40.0	26.9	70.0	63.5	0.47
DNAB/S -M6S -□	M63x1.5	-		40.0	26.9	70.0	63.5	0.67
DNAB/M -M6S -□	M63x1.5	-	44.1-54.0	40.0	15.0	84.0	76.2	0.49
DNAB/S -M7S -□	M75x1.5	-		40.0	26.9	84.0	76.2	0.76
DNAB/M -N6S -□	-	2"	44.1-54.0	40.0	26.9	84.0	76.2	0.52
DNAB/S -N7S -□	-	2-1/2"		40.0	39.9	84.0	76.2	0.95
DNAB/M -M6L -□	M63x1.5	-	44.1-54.0	40.0	15.0	84.0	76.2	0.49
DNAB/S -M7L -□	M75x1.5	-		40.0	26.9	84.0	76.2	0.76
DNAB/M -N6L -□	-	2"	44.1-54.0	40.0	26.9	84.0	76.2	0.52
DNAB/S -N7L -□	-	2-1/2"		40.0	39.9	84.0	76.2	0.95

