



Cable Fitting: Cable Gland for Armoured Cable, DAC Series

Flameproof/ Increased Safety and Dust protection by enclosure

Zone 1 & 2 – 21 & 22

Application

The DAC cable glands are suitable for used in zone 1, 2 and zone 21, 22 hazardous areas to enable direct insertion of SWA-steel wire armoured cable into Ex d equipment or enclosure.

Specification

Body, gland nut : Brass
(optional nickel-plated brass)
Thread seal : Nylon (PA6)
(for metric threads only)

Catalogue Number Logic

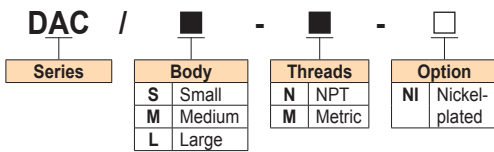

Technical Data

Hazardous Area	Gas	Dust
Zones	1 & 2	21 & 22
Equipment Group/Category	II 2G	II 2D
Symbol of Protection	Ex db eb IIC Gb	Ex tb IIIC Db
Certificate No.	TÜV CY 18 ATEX 0206101X	
T Rating	Temperature class of enclosure to which will be connected.	
Conformity to Standards	EN 60079-0:2012/A11:2013, EN 60079-1:2014, EN 60079-7:2015, EN 60079-31:2014	
Ambeint Temperature	-20°C to +75°C	
Index of Protection	IP66	

Note: Cables for fixed installations shall have flame propagation characteristics which enable them to withstand the tests according to IEC 60332-1-2 or IEC 60332-3-22.



Brass



Nickel-plated brass

Ordering Requirements

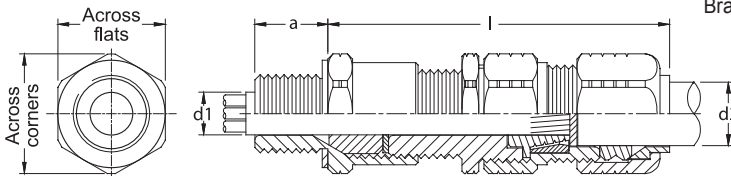

Neoprene inner sealing ring

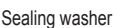

Sealing washer



Clamping cone-A



Clamping cone-B



Bush sleeve

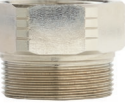

Inner gland nut



Neoprene outer sealing ring

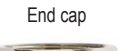

End cap

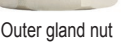

Outer gland nut

Cat. No.	Entries Threads (Male)		Cable Diameter		Armour Wire Dia.	Dimension in mm.				Approx. Weight (kgs.)	Shroud Ref.	
	Metric	NPT	Inner 'd1'	Outer 'd2'		l	a	Across Corners	Across Flats			
DAC/S -M0	- □	M16x1.5	-	3.0-8.6	6.0-13.4	0.9	65.0	15.0	26.5	24.0	0.13	SPV-24
DAC/S -M1	- □	M20x1.5	-	6.1-11.9	9.5-16.0	0.9/1.25	65.0	19.8	26.5	24.0	0.14	SPV-24
DAC/S -N1	- □	-	1/2"				65.0	19.8	26.5	24.0		
DAC/M -M1	- □	M20x1.5	-	6.5-14.3	12.5-20.9	0.9/1.25	73.0	15.0	35.0	31.75	0.20	SPV-31
DAC/S -M2	- □	M25x1.5	-				73.0	19.8	35.0	31.75	0.20	
DAC/L -M1	- □	M20x1.5	-	11.1-20.2	16.9-26.2	1.25/1.6	81.0	15.0	42.0	38.1	0.37	SPV-38
DAC/S -M2	- □	M25x1.5	-				81.0	20.1	42.0	38.1	0.39	
DAC/L -N1	- □	-	1/2"	17.0-26.5	22.0-31.9	1.6/2.0	92.0	15.0	49.0	44.4	0.60	SPV-44
DAC/S -N2	- □	-	3/4"				92.0	25.0	49.0	44.4	0.60	
DAC/M -M2	- □	M25x1.5	-	22.0-32.5	26.0-38.5	1.6/2.0	96.0	15.0	56.0	50.8	0.80	SPV-50
DAC/S -M3	- □	M32x1.5	-				96.0	25.0	56.0	50.8		
DAC/M -N2	- □	-	3/4"	29.5-38.1	35.0-46.8	1.8/2.5	98.0	15.0	63.0	57.1	0.90	SPV-57
DAC/S -N3	- □	-	1"				98.0	25.0	63.0	57.1		
DAC/M -M3	- □	M32x1.5	-	35.6-44.0	38.0-50.1	1.8/2.5	98.0	15.0	70.0	63.5	1.00	SPV-63
DAC/S -M4	- □	M40x1.5	-				98.0	26.9	70.0	63.5		
DAC/M -N3	- □	-	1"	39.0-44.0	47.0-55.0	1.8/2.5	99.0	15.0	84.0	76.2	1.35	SPV-76
DAC/S -N4	- □	-	1-1/4"				99.0	26.9	84.0	76.2		
DAC/M -M4	- □	M40x1.5	-	44.1-54.0	55.1-65.0	1.8/2.5	99.0	15.0	84.0	76.2	1.35	SPV-76
DAC/S -M5	- □	M50x1.5	-				99.0	26.9	84.0	76.2		
DAC/M -N4	- □	-	1-1/4"	44.1-54.0	55.1-65.0	1.8/2.5	99.0	15.0	84.0	76.2	1.35	SPV-76
DAC/S -N5	- □	-	1-1/2"				99.0	26.9	84.0	76.2		
DAC/M -M5	- □	M50x1.5	-	44.1-54.0	55.1-65.0	1.8/2.5	99.0	15.0	84.0	76.2	1.35	SPV-76
DAC/S -M6	- □	M63x1.5	-				99.0	26.9	84.0	76.2		
DAC/M -N5	- □	-	1-1/2"	44.1-54.0	55.1-65.0	1.8/2.5	99.0	15.0	84.0	76.2	1.35	SPV-76
DAC/S -N6	- □	-	2"				99.0	26.9	84.0	76.2		
DAC/M -M6	- □	M63x1.5	-	44.1-54.0	55.1-65.0	1.8/2.5	99.0	15.0	84.0	76.2	1.35	SPV-76
DAC/S -M7S	- □	M75x1.5	-				99.0	26.9	84.0	76.2		
DAC/M -N6	- □	-	2"	44.1-54.0	55.1-65.0	1.8/2.5	99.0	15.0	84.0	76.2	1.35	SPV-76
DAC/S -N7S	- □	-	2-1/2"				99.0	26.9	84.0	76.2		
DAC/M -M6L	- □	M63x1.5	-	44.1-54.0	55.1-65.0	1.8/2.5	99.0	15.0	84.0	76.2	1.35	SPV-76
DAC/S -M7L	- □	M75x1.5	-				99.0	26.9	84.0	76.2		
DAC/M -N6L	- □	-	2"	44.1-54.0	55.1-65.0	1.8/2.5	99.0	15.0	84.0	76.2	1.35	SPV-76
DAC/S -N7L	- □	-	2-1/2"				99.0	26.9	84.0	76.2		