

# Cable Fitting: Barrier Cable Gland for Armoured Cable, DACB Series

Flameproof/ Increased Safety and Dust protection by enclosure

Zone 1 & 2 – 21 & 22



## Application

The DACB cable glands are suitable for used to direct insertion of SWA-steel wire armoured cable into Ex db or Ex eb equipment or enclosure.

## Specification

- Body, gland nut : Brass  
(optional nickel-plated brass)
- Thread seal : Nylon (PA6)  
(for metric threads only)
- Seal : Putty compound, -40°C to +120°C  
(2-part; resin/hardener)

## Technical Data

<b>Hazardous Area Zones</b>	<b>Gas</b>	<b>Dust</b>
II 2G	1 & 2	21 & 22
<b>Equipment Group/Category</b>	II 2G	II 2D
<b>Symbol of Protection</b>	Ex db IIC Gb / Ex eb IIC Gb	Ex tb IIIC Db
<b>T Rating</b>	Temperature class of enclosure to which will be connected.	
<b>Conformity to Standards</b>	EN IEC 60079-0:2018, EN 60079-1:2014, EN IEC 60079-7:2015/A1:2018, EN 60079-31:2014, IEC 60079-0:2017, IEC 60079-1:2014, IEC 60079-7:2015, IEC 60079-31:2013	
<b>Ambeint Temperature</b>	-40°C to +75°C	
<b>Index of Protection</b>	IP66	

Note: Cables for fixed installations shall have flame propagation characteristics which enable them to withstand the tests according to IEC 60332-1-2 or IEC 60332-3-22.

## Catalogue Number Logic

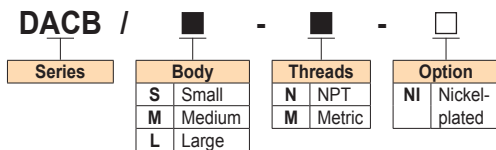

## Ordering Requirements

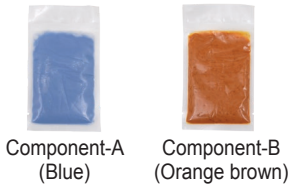
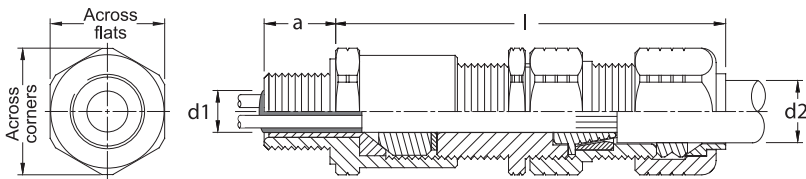

Cat. No.	Entries Threads (Male)		Cable Diameter		Armour Wire Dia.	Dimension in mm.				Approx. Weight (kgs.)
	Metric	NPT	Inner 'd1'	Outer 'd2'		l	a	Across Corners	Across Flats	
DACB /S -M0	-	-			0.9	65.0	15.0	26.5	24.0	0.13
DACB /S -M1	-	-	3.0-8.6	6.0-13.4		65.0	19.8	26.5	24.0	
DACB /S -N1	-	1/2"			0.9/1.25	65.0	15.0	26.5	24.0	0.14
DACB /M -M1	-	-	6.1-11.9	9.5-16.0		65.0	19.8	26.5	24.0	
DACB /M -N1	-	1/2"			0.9/1.25	73.0	15.0	35.0	31.75	0.20
DACB /L -M1	-	-	6.5-14.3	12.5-20.9		73.0	19.8	35.0	31.75	
DACB /L -N1	-	1/2"			1.25/1.6	73.0	20.1	35.0	31.75	0.20
DACB /S -N2	-	3/4"				73.0	15.0	42.0	38.1	
DACB /S -M2	-	-			1.6/2.0	81.0	15.0	42.0	38.1	0.39
DACB /M -M2	-	-	11.1-20.2	16.9-26.2		81.0	20.1	42.0	38.1	
DACB /S -N3	-	1"			1.6/2.0	92.0	15.0	49.0	44.4	0.60
DACB /M -M3	-	-	17.0-26.5	22.0-31.9		92.0	25.0	49.0	44.4	
DACB /S -M4	-	-			1.8/2.5	92.0	25.6	49.0	44.4	0.65
DACB /M -N3	-	1"				96.0	15.0	56.0	50.8	
DACB /M -M4	-	-	22.0-32.5	26.0-38.5	1.6/2.0	96.0	25.6	56.0	50.8	0.90
DACB /S -N5	-	1-1/4"				98.0	15.0	63.0	57.1	
DACB /M -M5	-	-	29.5-38.1	35.0-46.8	1.8/2.5	98.0	26.0	63.0	57.1	1.00
DACB /S -M6	-	-	35.6-44.0	38.0-50.1		98.0	15.0	70.0	63.5	
DACB /M -N5	-	1-1/2"			1.8/2.5	98.0	26.9	70.0	63.5	1.35
DACB /S -N6	-	2"				99.0	15.0	84.0	76.2	
DACB /M -M6S	-	-	39.0-44.0	47.0-55.0	1.8/2.5	99.0	26.9	84.0	76.2	1.35
DACB /S -M7S	-	-	44.1-54.0	55.1-65.0		99.0	39.9	84.0	76.2	
DACB /M -N6S	-	2"			1.8/2.5	99.0	15.0	84.0	76.2	1.35
DACB /S -N7S	-	2-1/2"				99.0	26.9	84.0	76.2	
DACB /M -M6L	-	-			1.8/2.5	99.0	26.9	84.0	76.2	1.35
DACB /S -M7L	-	-				99.0	39.9	84.0	76.2	
DACB /M -N6L	-	2"			1.8/2.5	99.0	15.0	84.0	76.2	1.35
DACB /S -N7L	-	2-1/2"				99.0	26.9	84.0	76.2	

